

# JAEGER

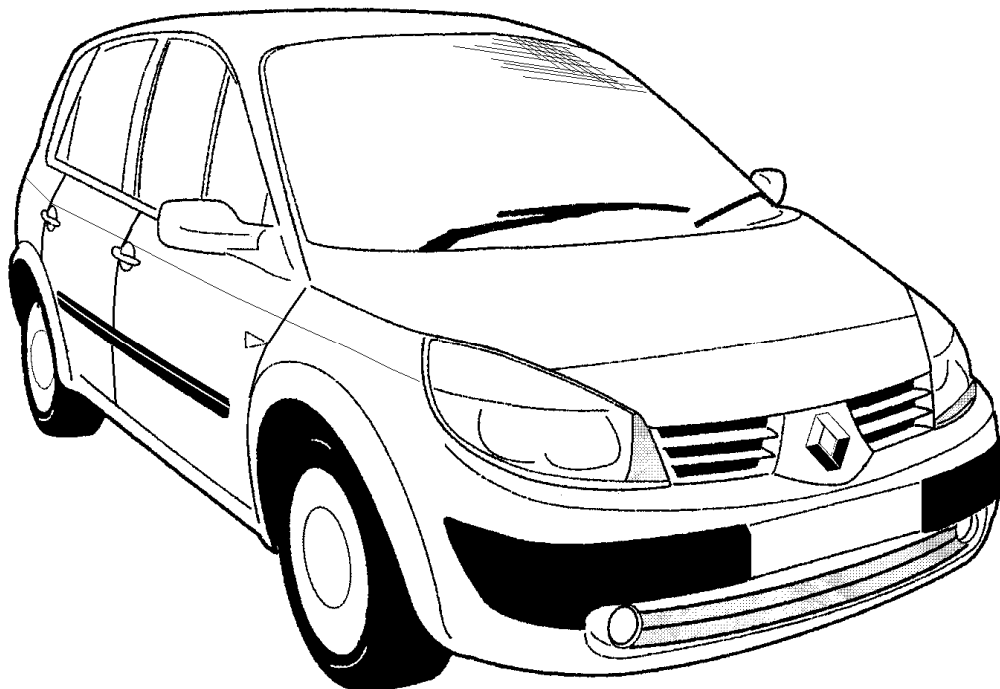

**RENAULT SCENIC 2**  
**RENAULT GRAND SCENIC**

**07/03>>05/09**  
**03/04>>03/09**

**Ohne Überwachung der Anhänger-Blinkleuchten!**

**Without monitoring of the trailer turn signals!**

**745093**

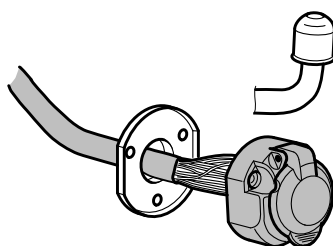

**13-PIN**

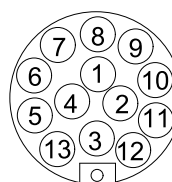

- (D)** Einbauanleitung
- (GB)** Fitting instructions
- (F)** Instructions de montage
- (E)** Instrucciones de montaje
- (NL)** Inbouwhandleiding
- (P)** Instruções de montagem
- (I)** Istruzioni di montaggio

- (CZ)** Pokyny pro montáž
- (H)** Felszerelési utasítás
- (PL)** Instrukcje wbudowania
- (GR)** Οδηγίες συναρμολόγησης
- (S)** Montageanvisning
- (SLO)** Navodila za instalacijo
- (TR)** Montaj talimatları

## KIT

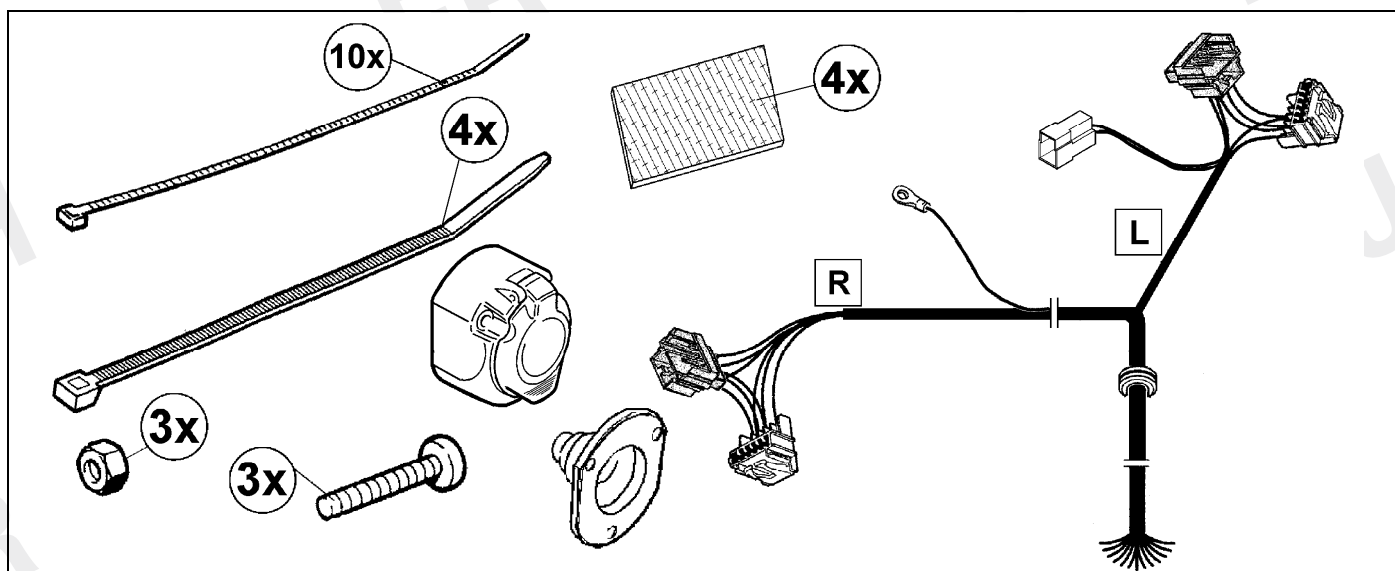

## TOOL

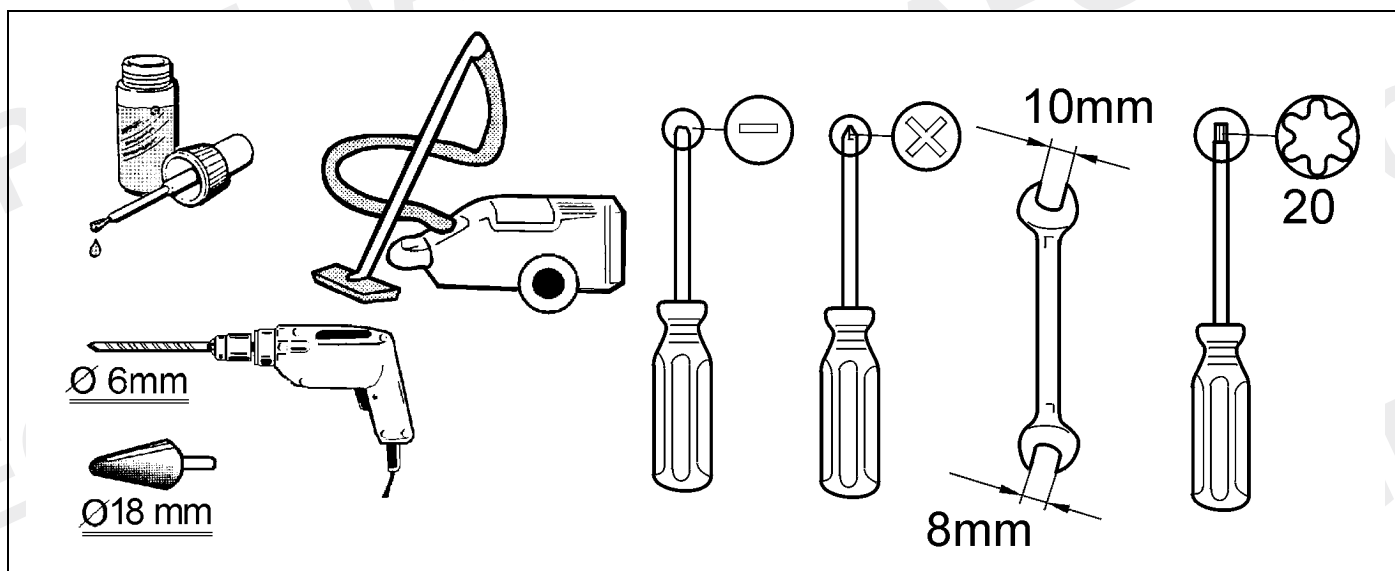

1

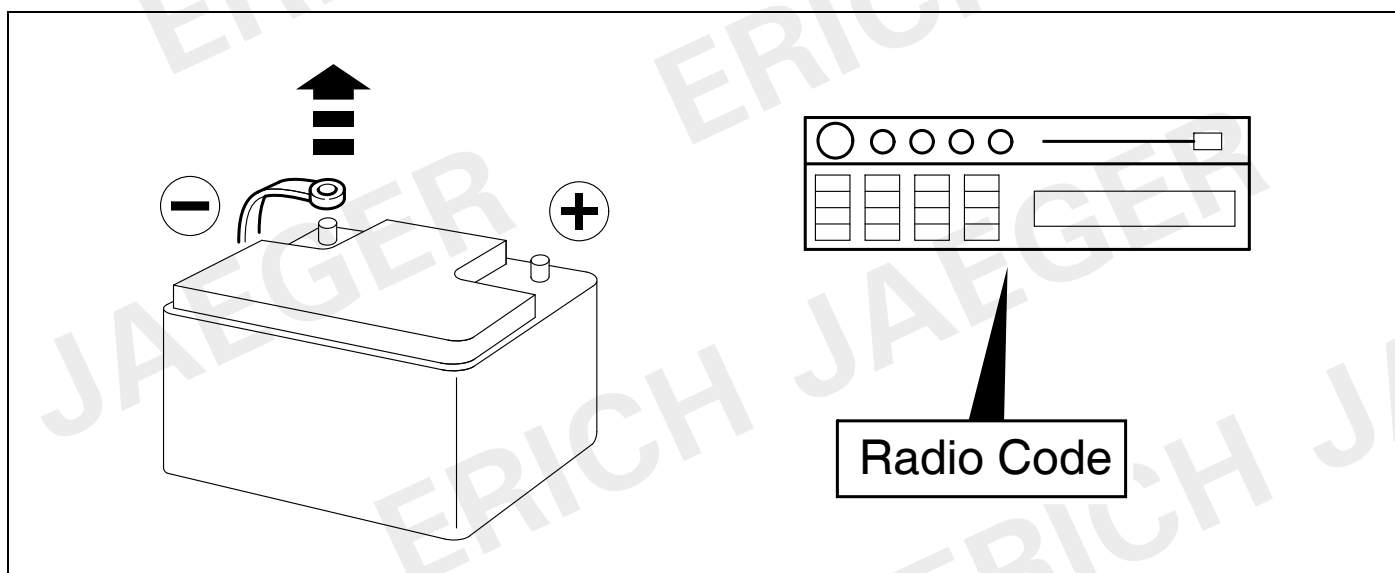

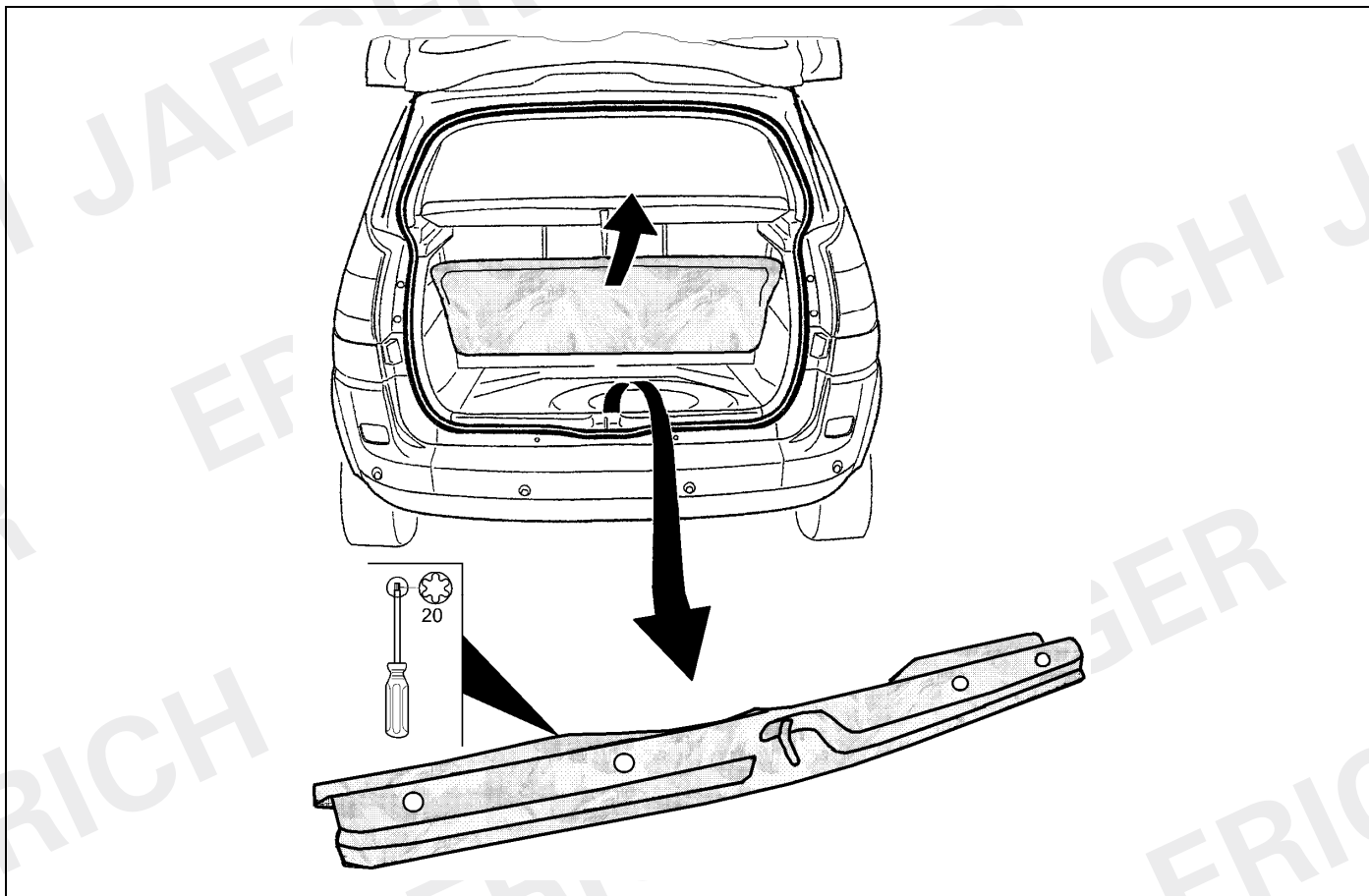
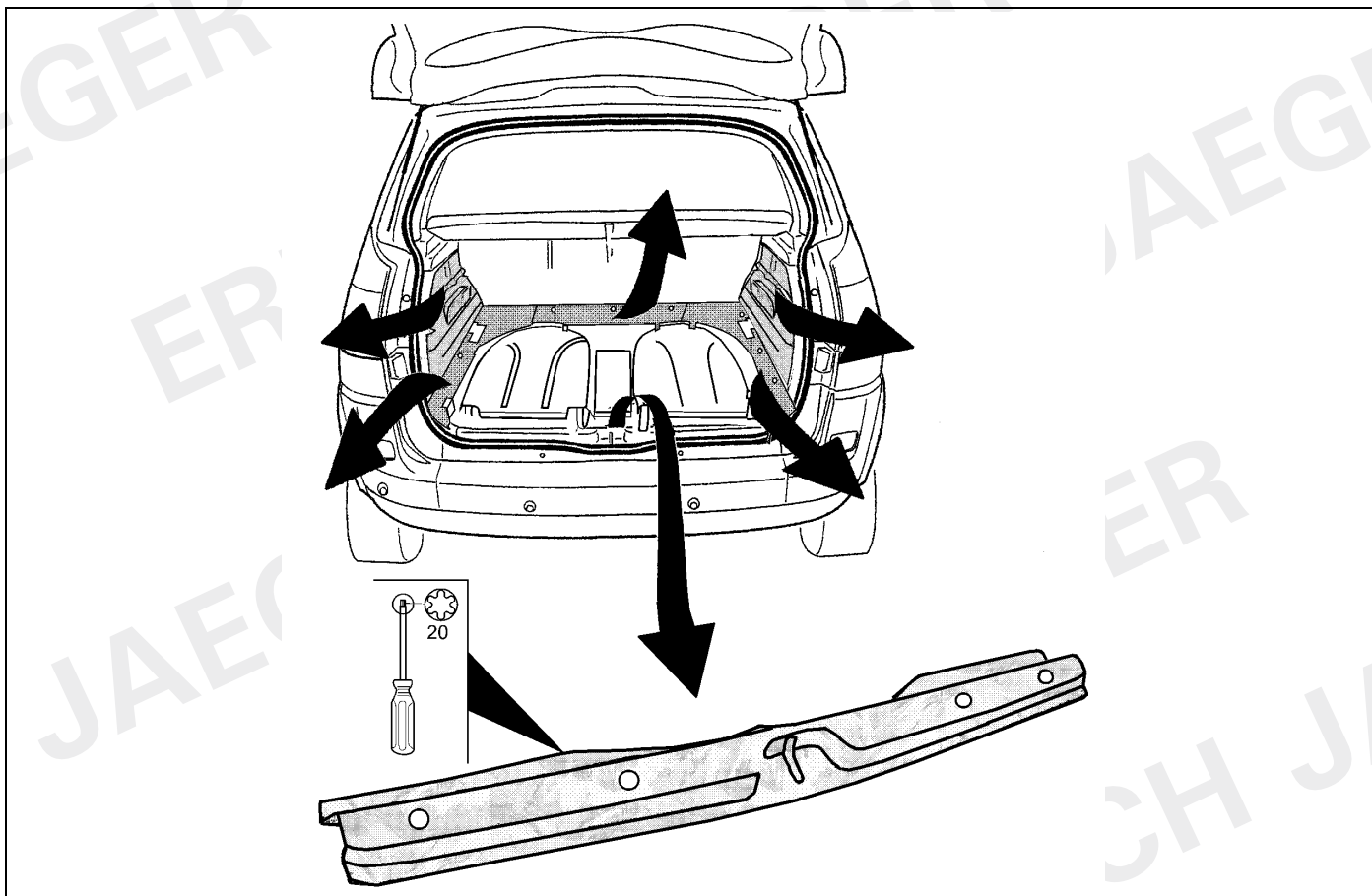
**2****SCENIC 2****2a****GRAND SCENIC**

3

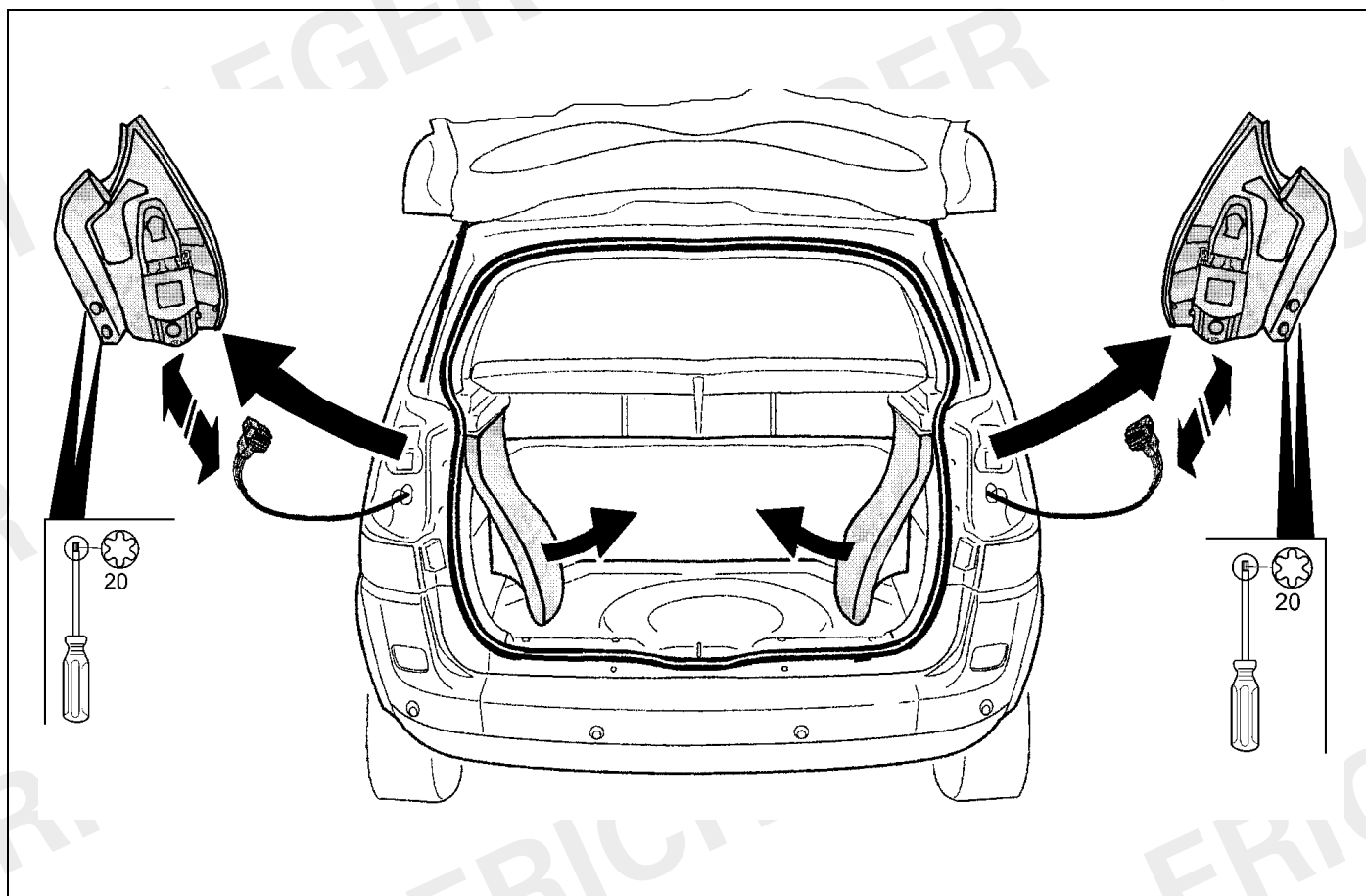

4

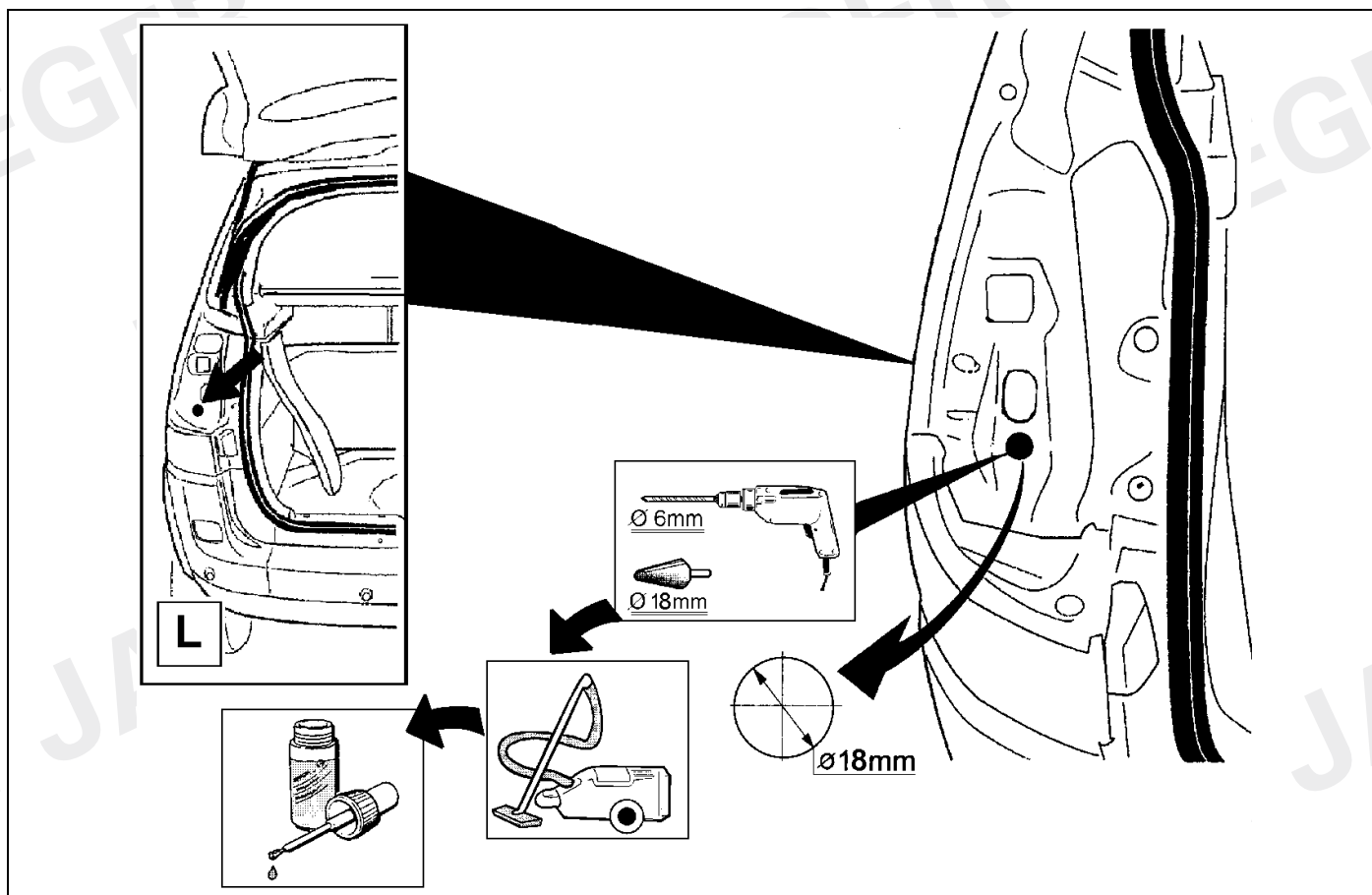

5

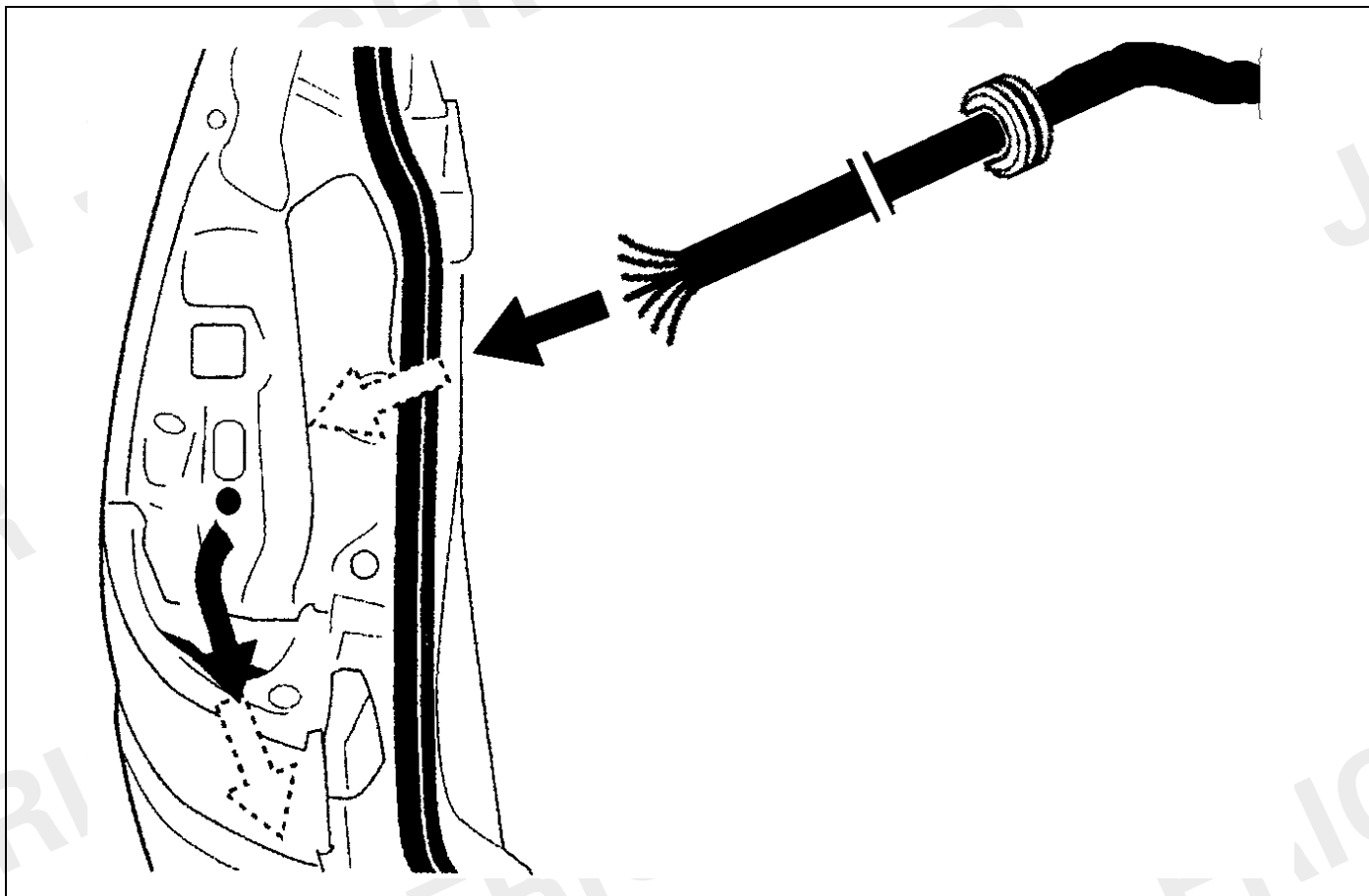



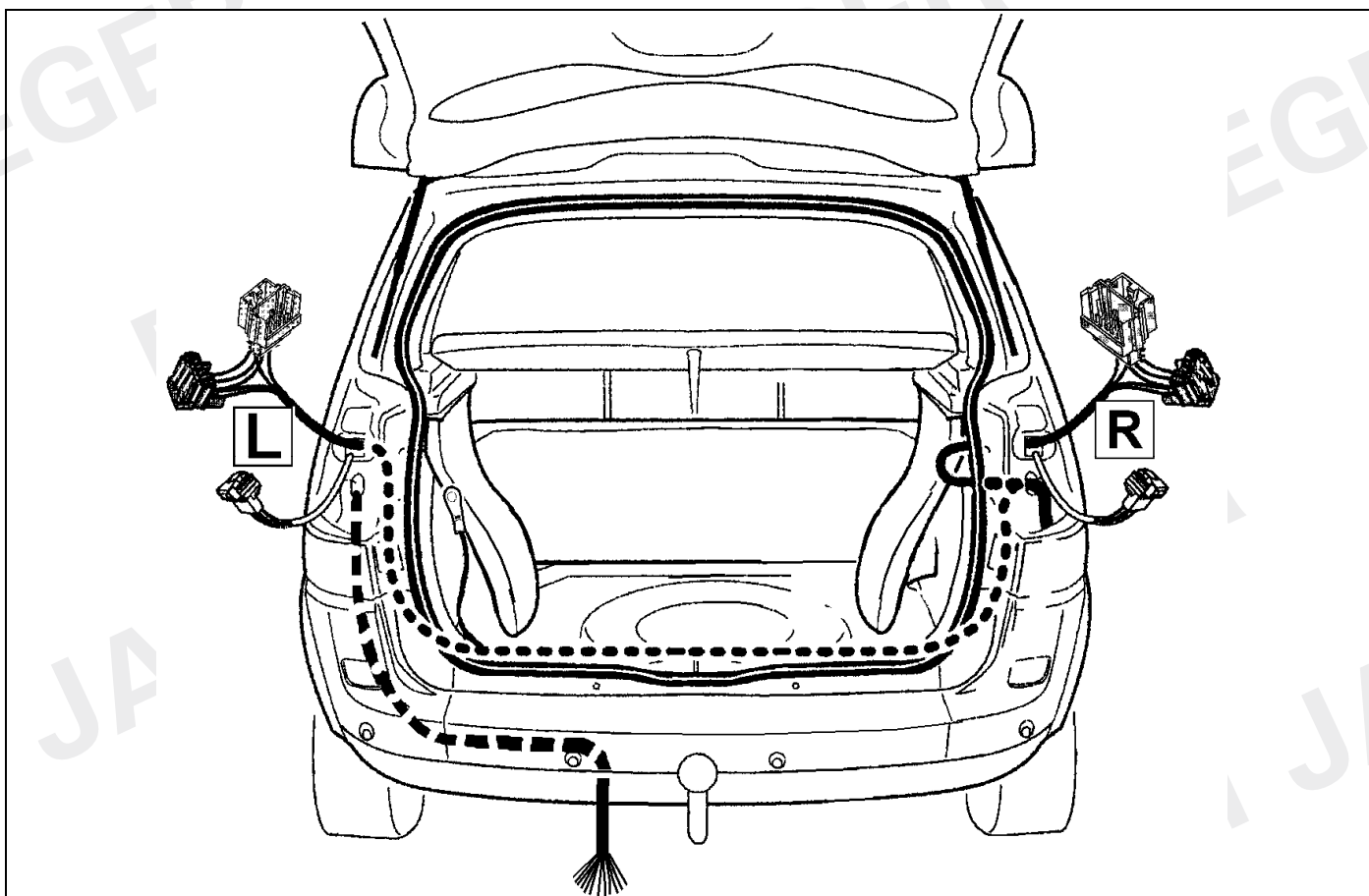

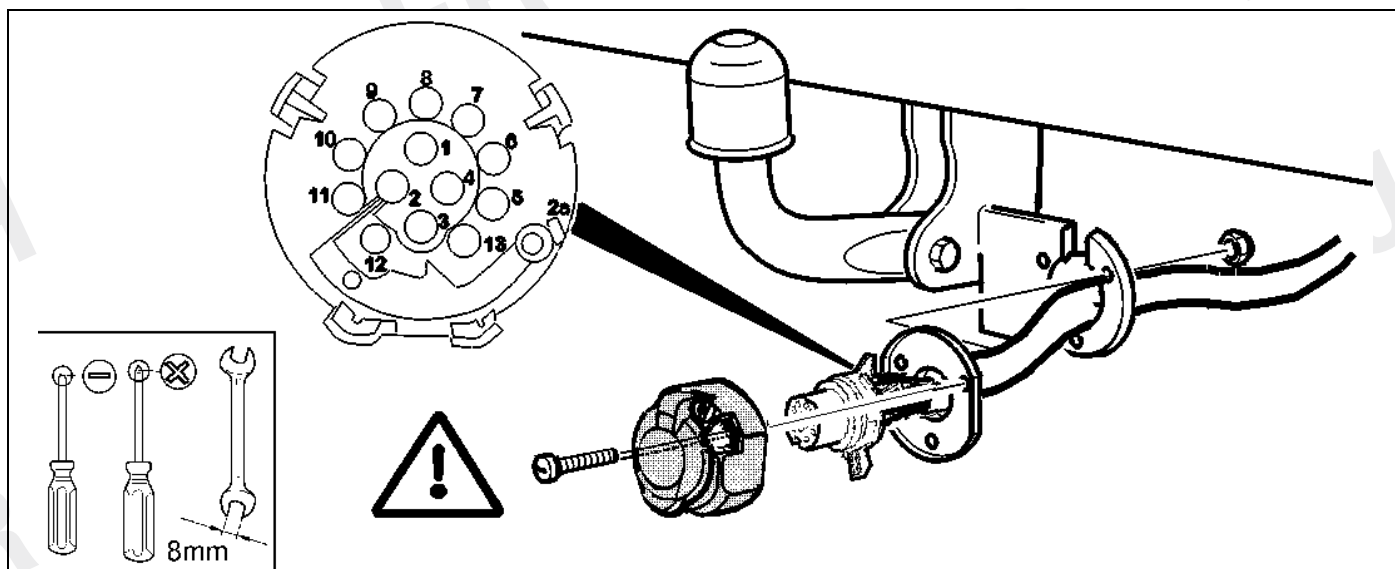





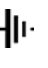



6



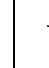



	D	GB	F	ESP	NL	P	I	CZ	H	PL	GR	S	SLO	TUR
														
1	schwarz/ weiß	black/ white	noir/ blanc	negro/ blanco	zwart/ wit	preto/ branco	nero/ bianco	černo/ bílý	fekete/ fehér	czarno/ biały	μαύρο/ λευκό	svart/ vít	črna/ bela	siyah/ beyaz
2	grau	grey	gris	gris	grijs	cinzento	grigio	šedý	szürke	szary	Γκρι	grá	siva	gri
3	weiß/ braun	white/ brown	blanc/ brun	blanco/ marrón	wit/ bruin	branco/ castanho	bianco/ marrone	bílá/ hnědo	fehér/ barna	biało/ brązowo	λευκό/ καφέ	vít/ brun	bela/ smeđa	beyaz/ kahverengi
4	schwarz/ grün	black/ green	noir/ vert	negro/ verde	zwart/ groen	preto/ verde	nero/ verde	černo/ zelený	fekete/ zöld	czarno/ zielony	μαύρο/ πράσινο	svart/ grön	črna/ zelena	siyah/ yeşil
5	grau/ rot	grey/ red	gris/ rouge	gris/ rojo	grijs/ rood	cinzento / vermelho	grigio/ rosso	šedo/ červený	szürke/ piros	szaro/ czerwony	γκρι/ κόκκινο	grá/ röd	siva/ rdeča	gri / kırmızı
6	schwarz/ rot	black/ red	noir/ rouge	negro/ rojo	zwart/ rood	preto/ vermelho	nero/ rosso	černo/ červený	fekete/ piros	czarno/ czerwony	μαύρο/ κόκκινο	svart/ röd	črna/ rdeča	siyah/ kırmızı
7	grau/ schwarz	grey/ black	gris/ noir	gris/ negro	grijs/ zwart	cinzento / preto	grigio/ nero	šedo/ černý	szürke/ fekete	szaro/ czarny	γκρι/ μαύρο	grá/ svart	siva/ črna	gri / siyah
8	blau/ rot	blue/ red	bleu/ rouge	azul/ rojo	blauw/ rood	azul/ vermelho	blu/ rosso	modro/ červený	kék/ piros	niebiesko/ czerwony	μπλε/ κόκκινο	blá/ röd	modra/ rdeča	mavi/ kırmızı
9	rot	red	rouge	rojo	rood	vermelho	rosso	červenó	piros	czerwony	κόκκινος	röd	rdeča	kırmızı
10	nicht belegt	vacant	inutilisé	no ocupado	niet aangesloten	não ocupado	libero	neobsazen	nem foglalt	wolny	δεν είναι κα τελετημένος	ej använd	ni zasedeno	boş
11	nicht belegt	vacant	inutilisé	no ocupado	niet aangesloten	não ocupado	libero	neobsazen	nem foglalt	wolny	δεν είναι κα τελετημένος	ej använd	ni zasedeno	boş
12	nicht belegt	vacant	inutilisé	no ocupado	niet aangesloten	não ocupado	libero	neobsazen	nem foglalt	wolny	δεν είναι κα τελετημένος	ej använd	ni zasedeno	boş
13	braun	brown	brun	marrón	bruin	castanho	marrone	hnědo	barna	brązowo	καφέ	brun	smeđa	kahverengi
2a	grau/ weiß	grey/ white	gris/ blanc	gris/ blanco	grijs/ wit	cinzento / branco	grigio/ bianco	šedý/ bílý	szürke/ fehér	szaro/ biały	γκρι/ λευκό	grá/ vít	siva/ bela	gri/ beyaz

9

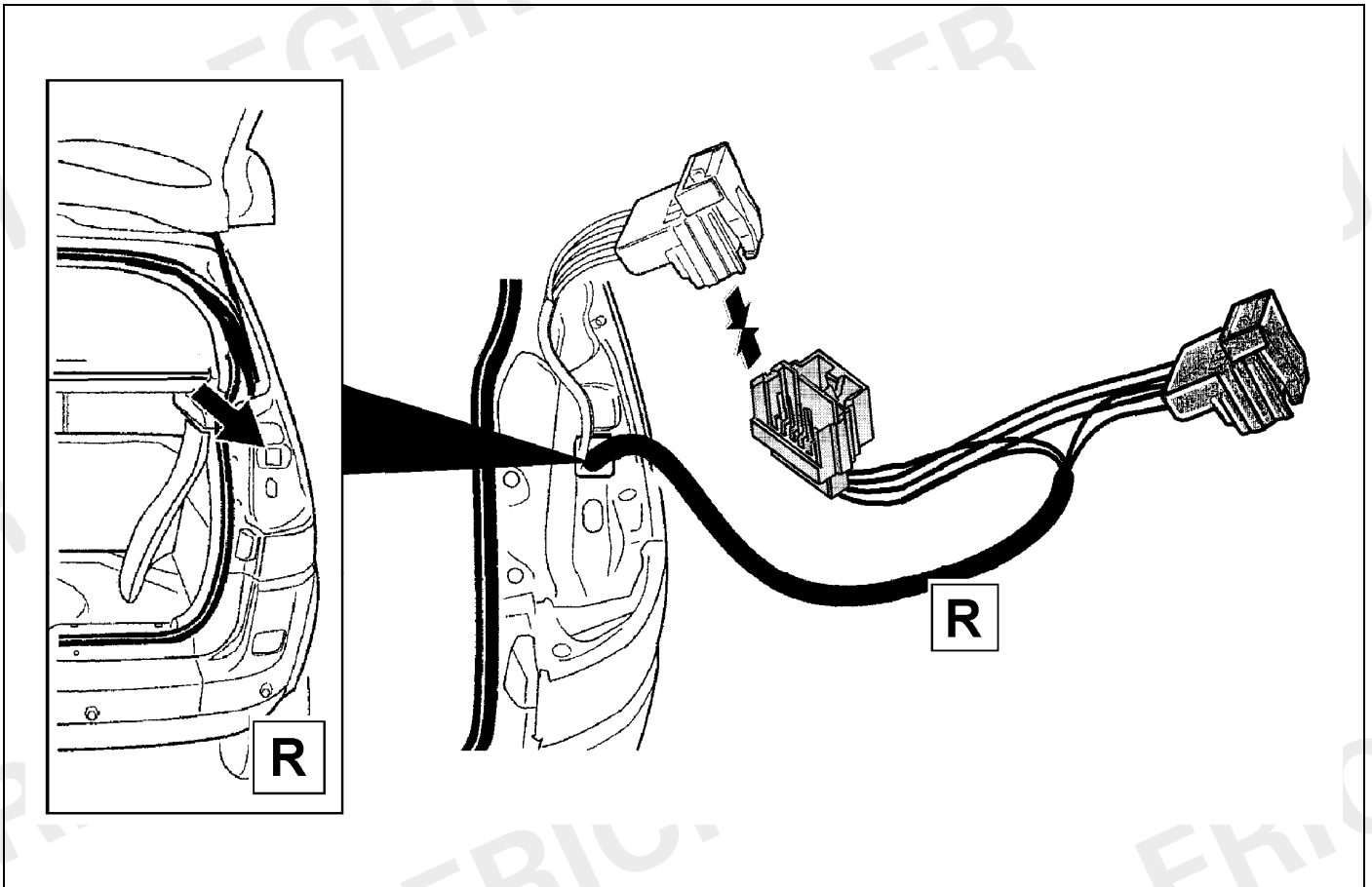

10

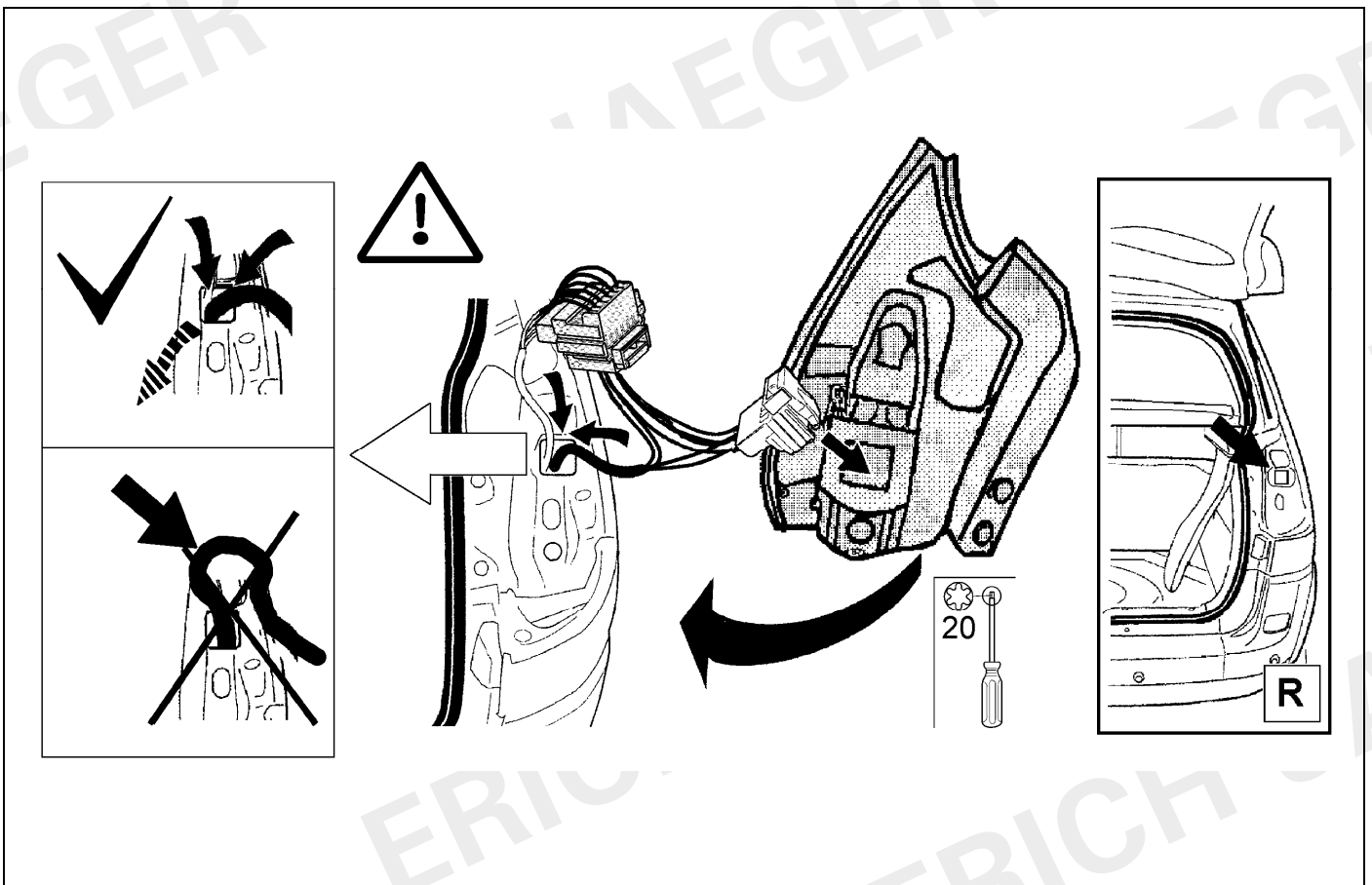



11

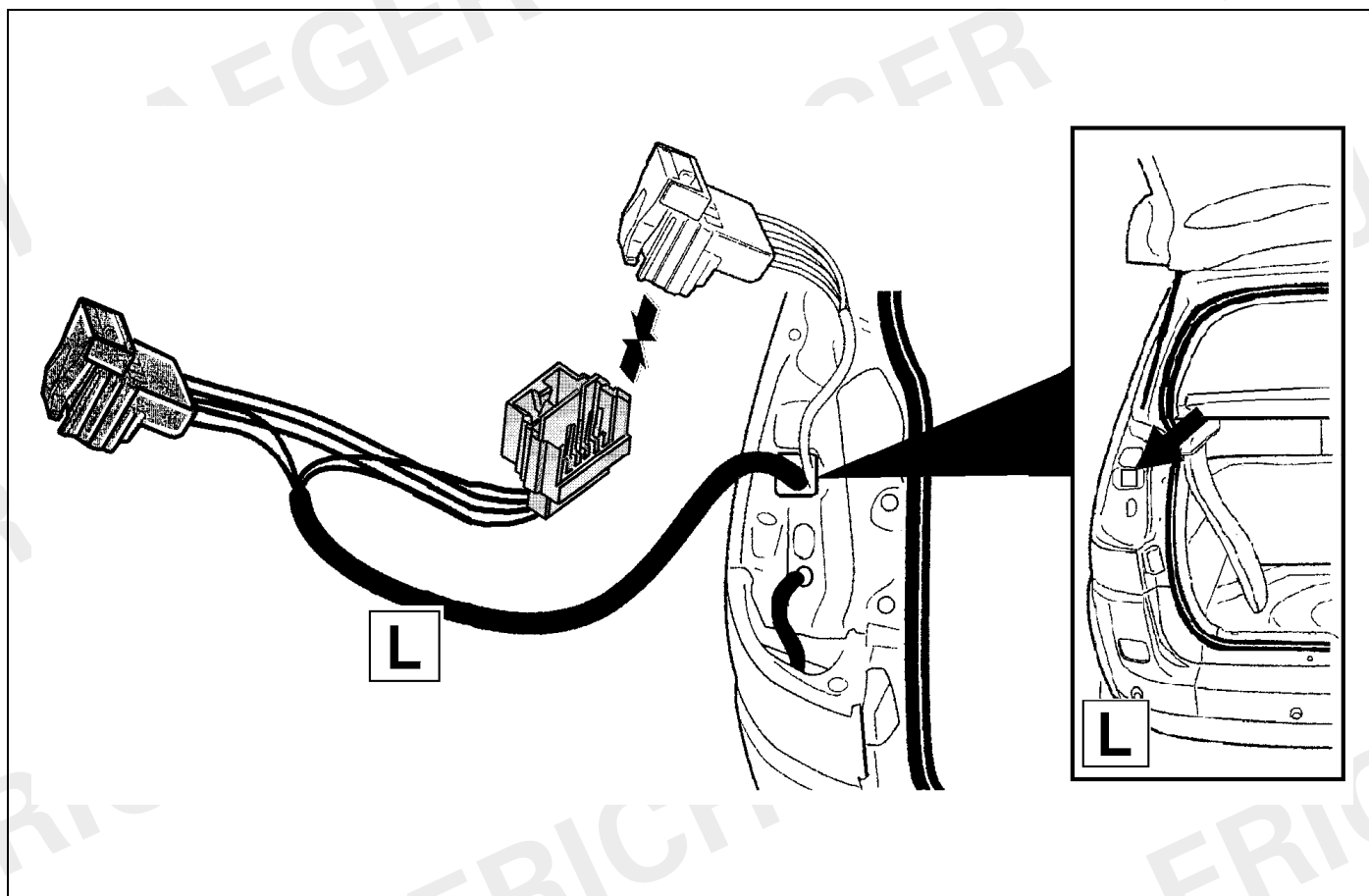

12

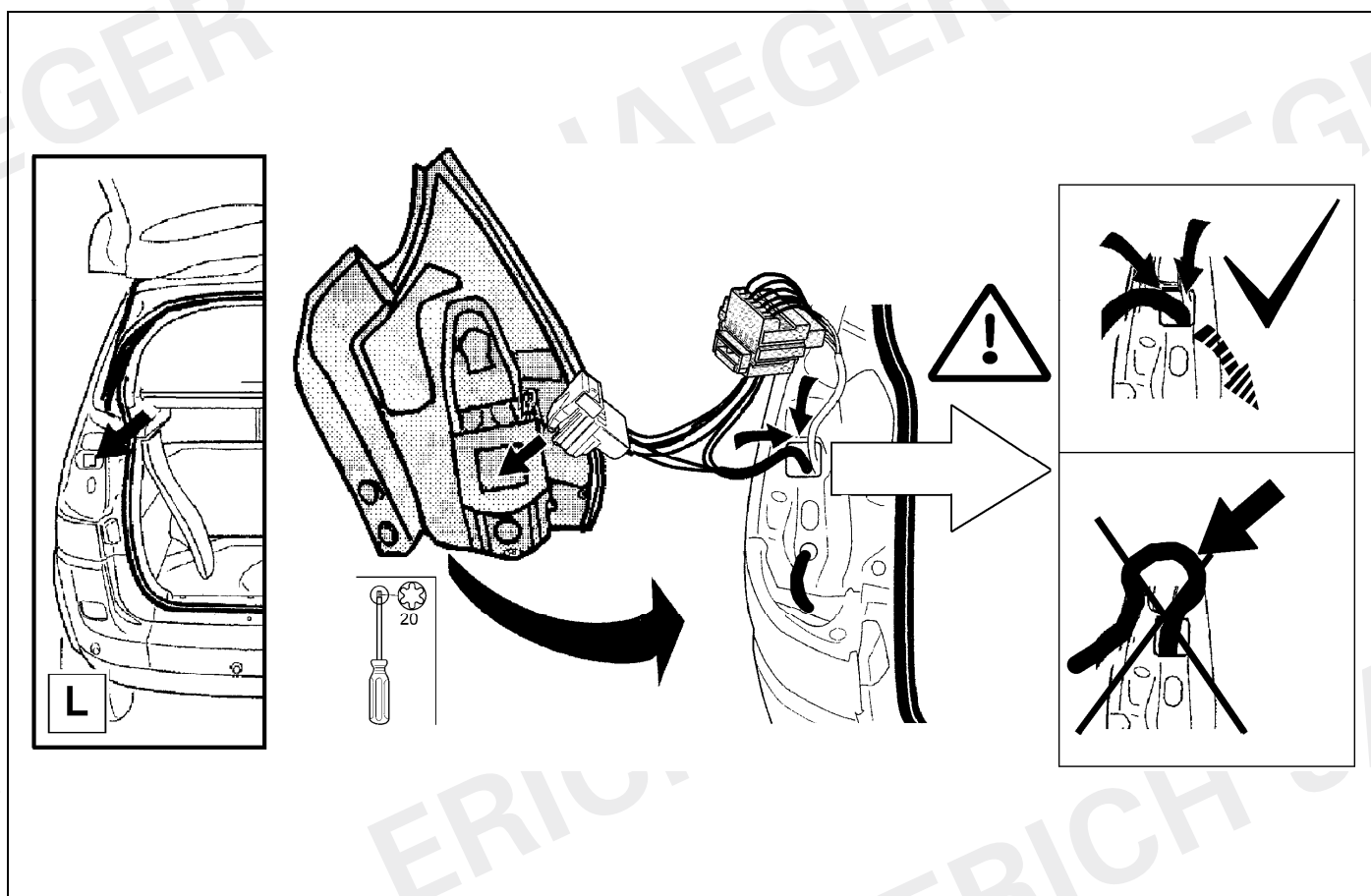

13

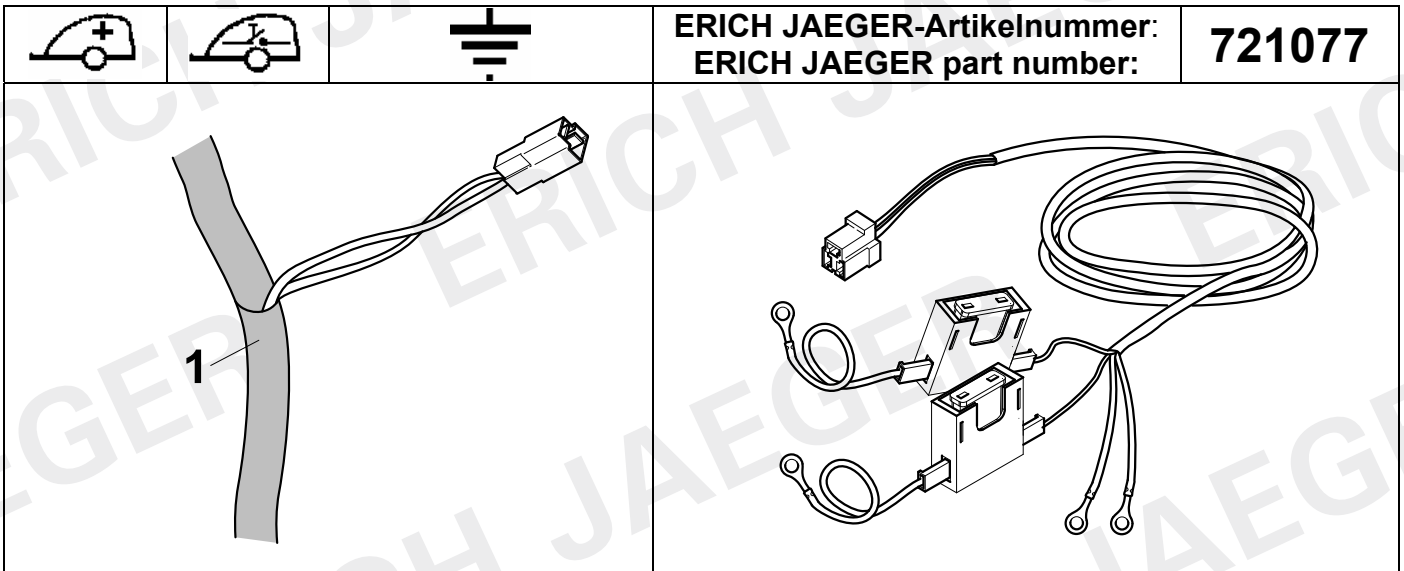
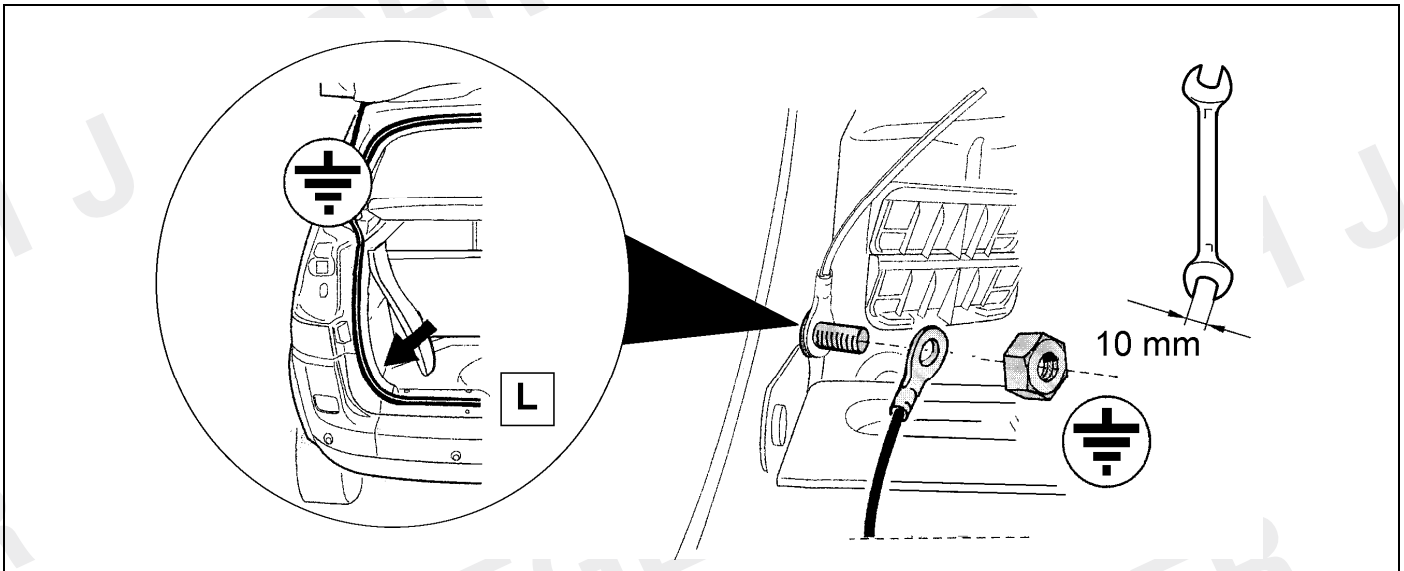

14

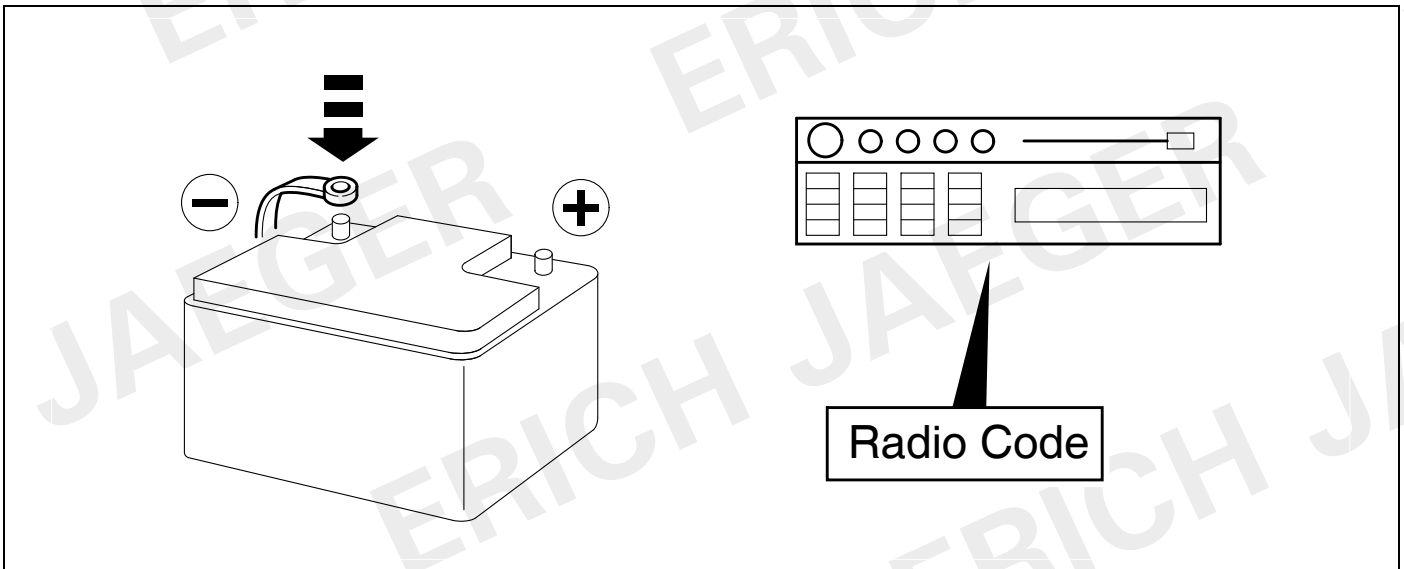

- |                               |                               |
|-------------------------------|-------------------------------|
| (D) Funktionen kontrollieren! | (CZ) Zkontrolujte funkci!     |
| (GB) Check functions!         | (H) Ellenőrizze a funkciókat! |
| (F) Contrôler les fonctions!  | (PL) Sprawdź działanie!       |
| (E) Compruebe las funciones!  | (GR) Έλεγχος λειτουργίας!     |
| (NL) Controleer functies!     | (S) Kontrollera funktionerna! |
| (P) Verifique as funções!     | (SLO) Preverite delovanje!    |
| (I) Controllare le funzioni!  | (TR) İşlevleri kontrol edin!  |

311069

311052

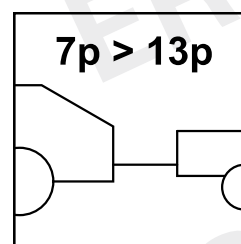
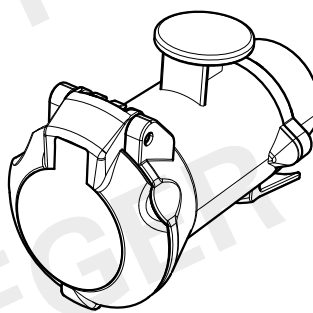
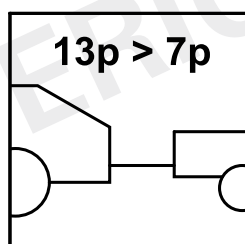
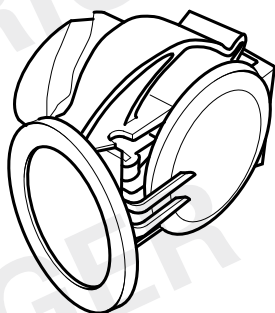

- |   |   |
|---|---|
| (D) Technische Änderungen vorbehalten!        | (CZ) Technická práva vyhrazena!                                   |
| (GB) Subject to change!                       | (H) Műszaki módosítások joga fenntartva!                          |
| (F) Sous réserve de modifications techniques! | (PL) Zastrzegamy sobie możliwość wprowadzenia zmian technicznych! |
| (E) Salvo modificaciones técnicas!            | (GR) Διατηρούμε το δικαίωμα των τεχνικών αλλαγών!                 |
| (NL) Technische wijzigingen voorbehouden!     | (S) Ändringar förbehålls!   |
| (P) Sujeito a modificações técnicas!          | (SLO) Pravice do sprememb pridržane!                              |
| (I) Salvo modificaciones técnicas!            | (TR) Teknik değışiklikler mahfuzdur!                              |