

# JAEGER

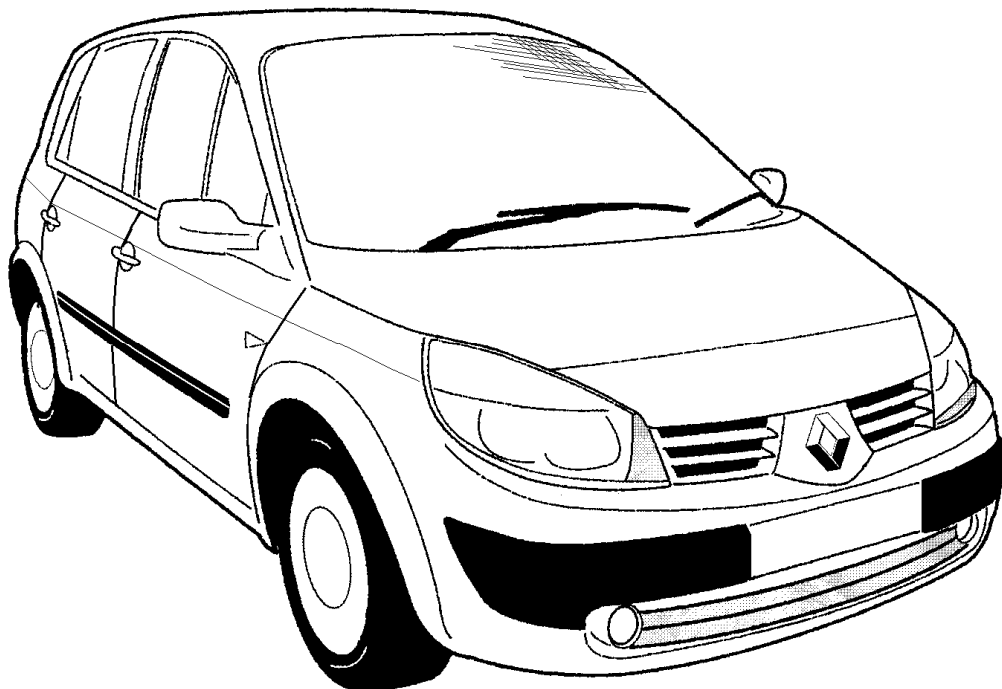

**RENAULT SCENIC 2**  
**RENAULT GRAND SCENIC**

**07/03>>05/09**

**03/04>>03/09**

**Ohne Überwachung der Anhänger-Blinkleuchten!**

**Without monitoring of the trailer turn signals!**

**735106**

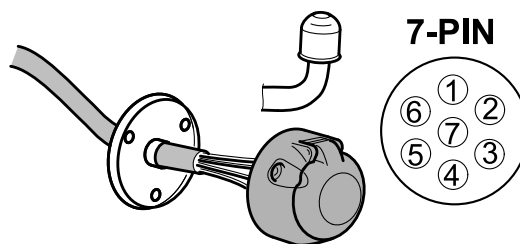

- (D) Einbauanleitung
- (GB) Fitting instructions
- (F) Instructions de montage
- (E) Instrucciones de montaje
- (NL) Inbouwhandleiding
- (P) Instruções de montagem
- (I) Istruzioni di montaggio

- (CZ) Pokyny pro montáž
- (H) Felszerelési utasítás
- (PL) Instrukcje wbudowania
- (GR) Οδηγίες συναρμολόγησης
- (S) Montageanvisning
- (SLO) Navodila za instalacijo
- (TR) Montaj talimatları

# KIT

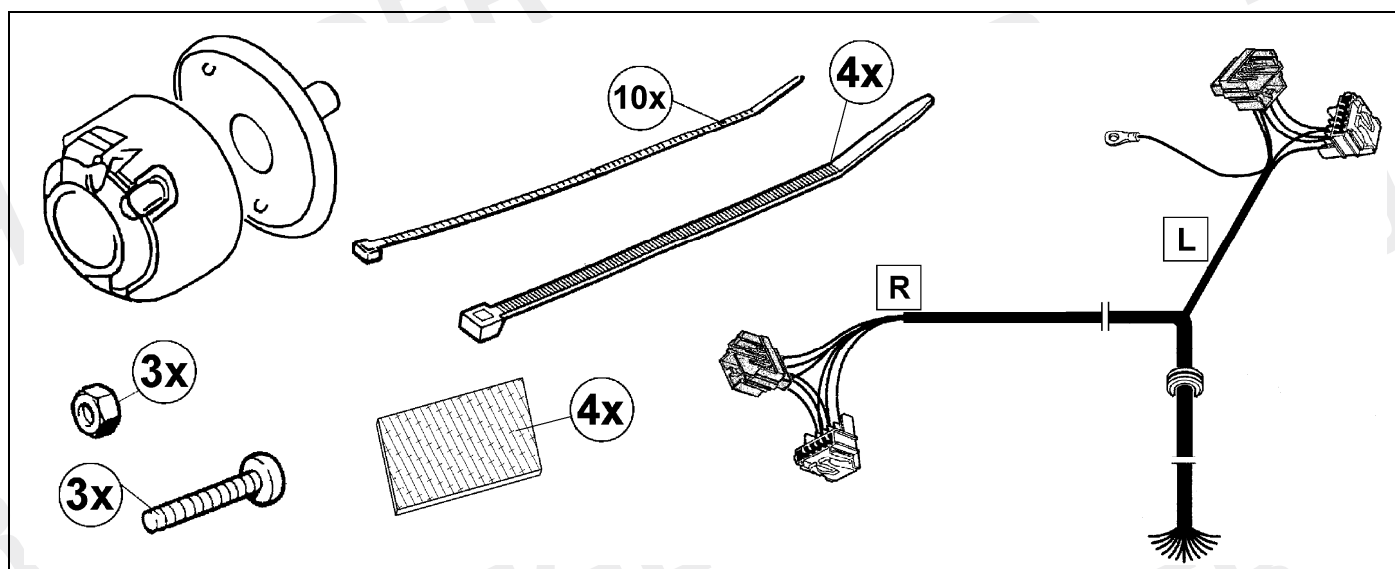

# TOOL

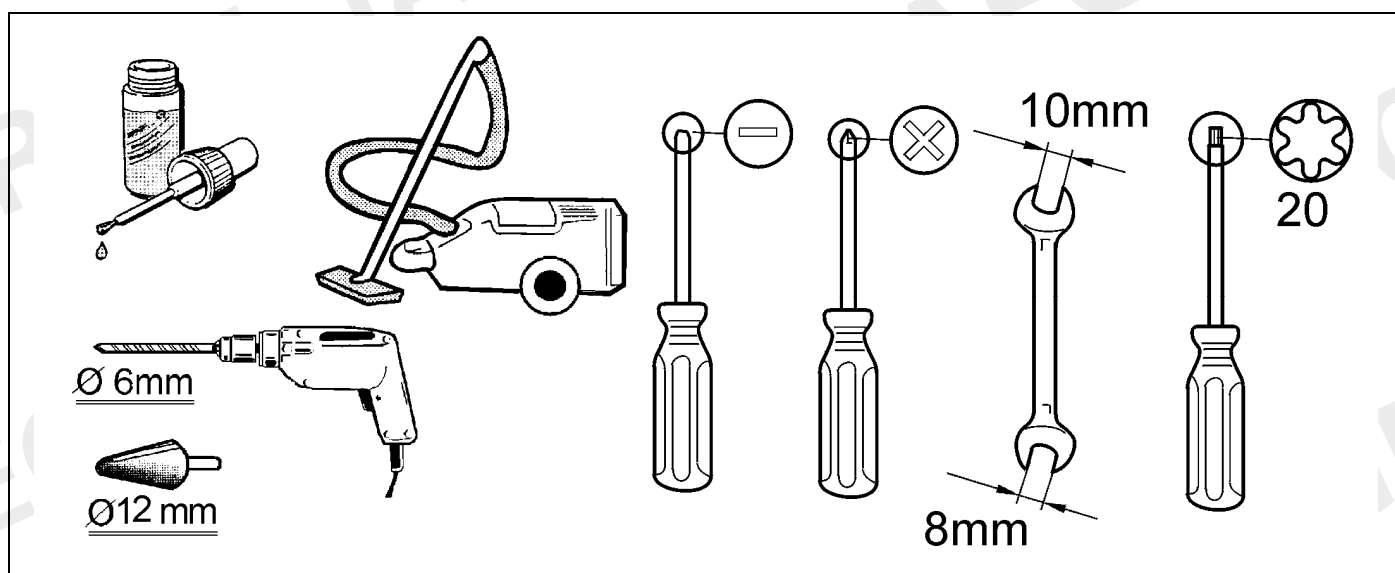

1

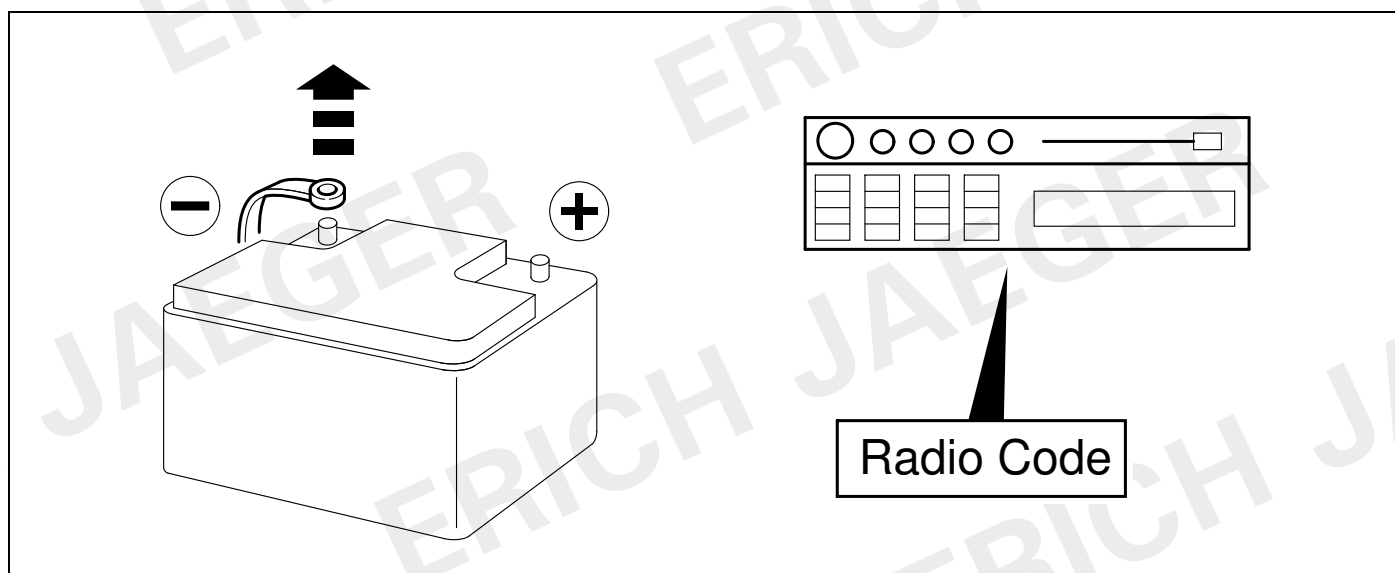

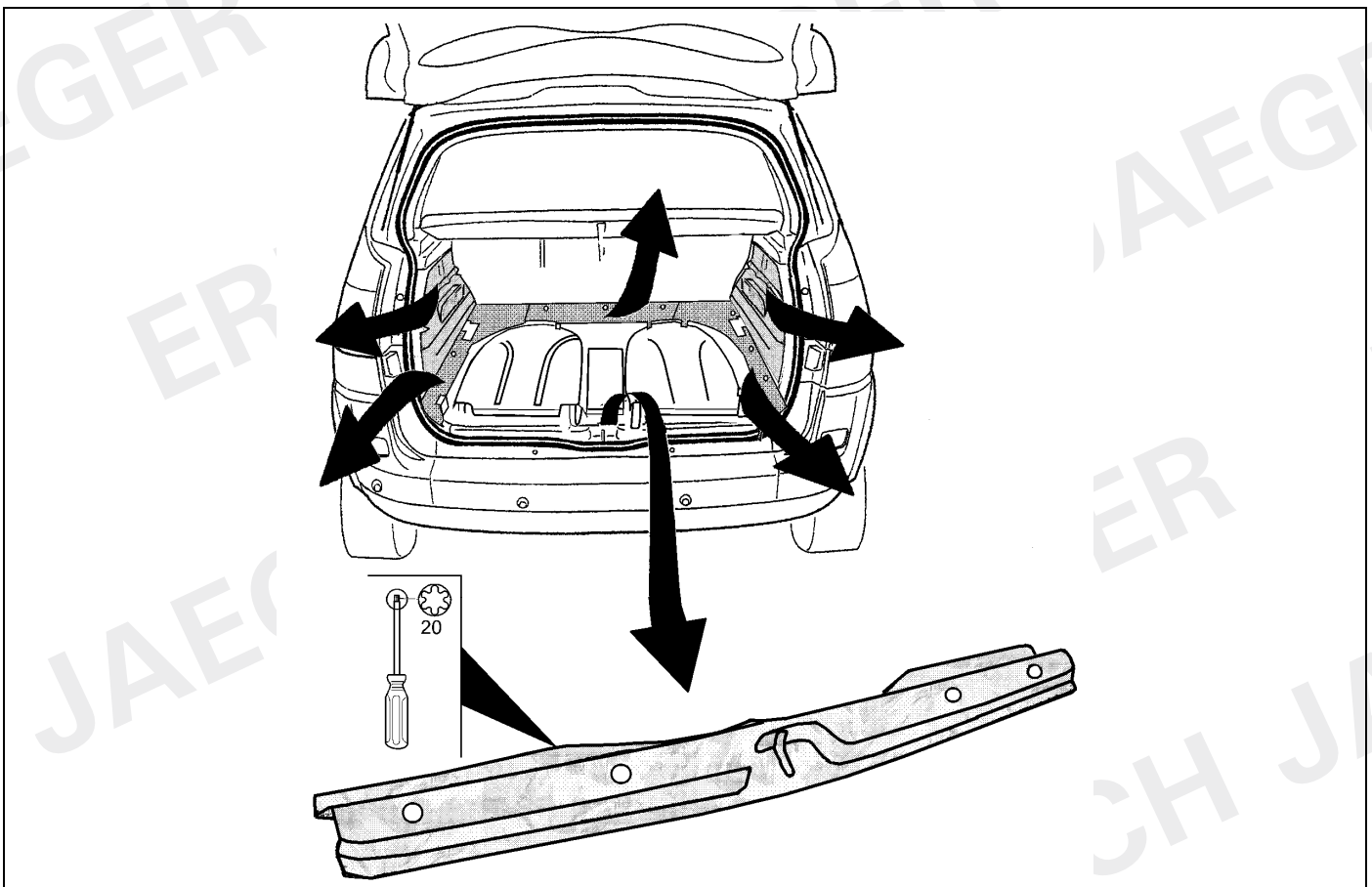
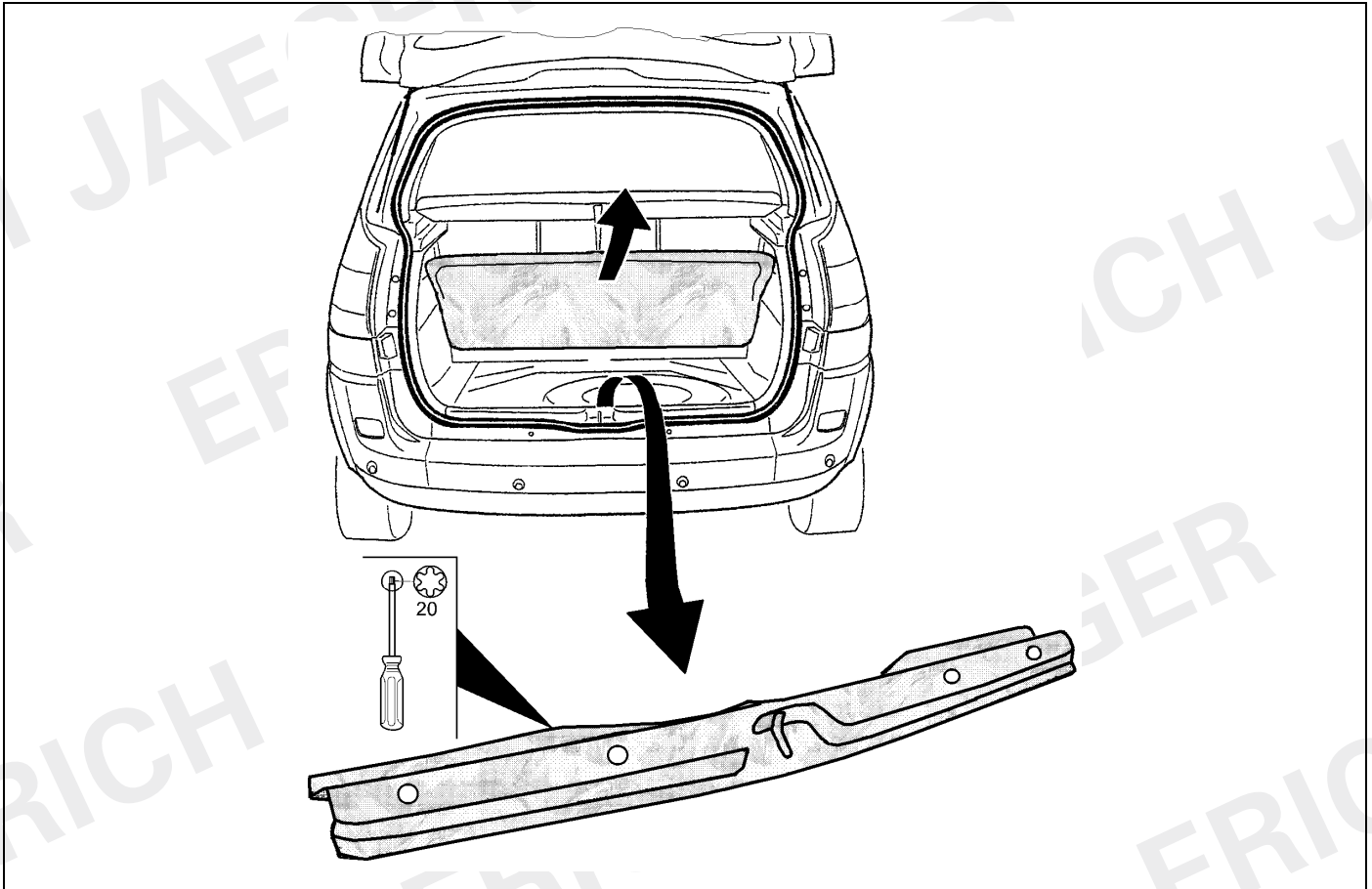

3

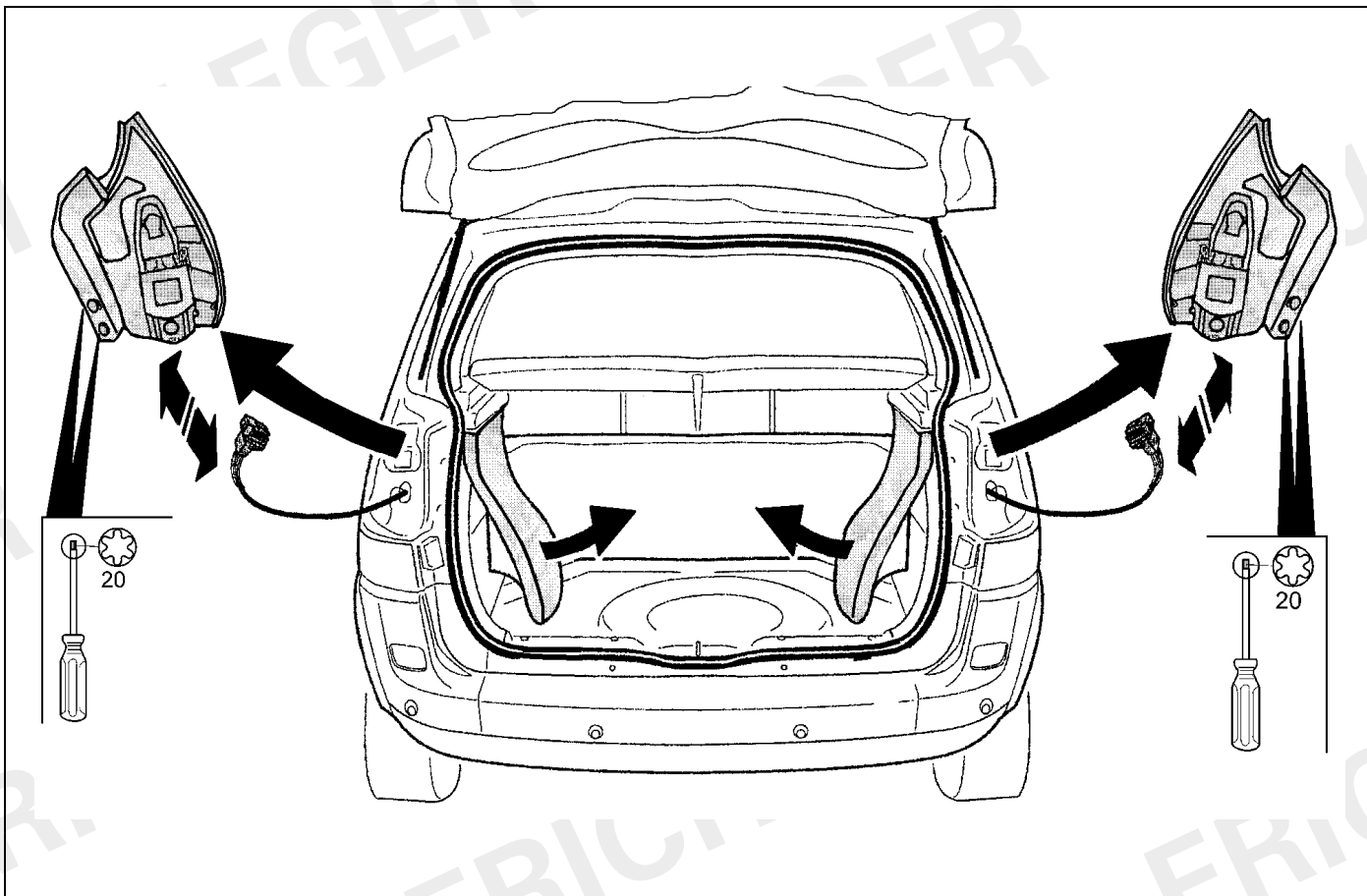

4

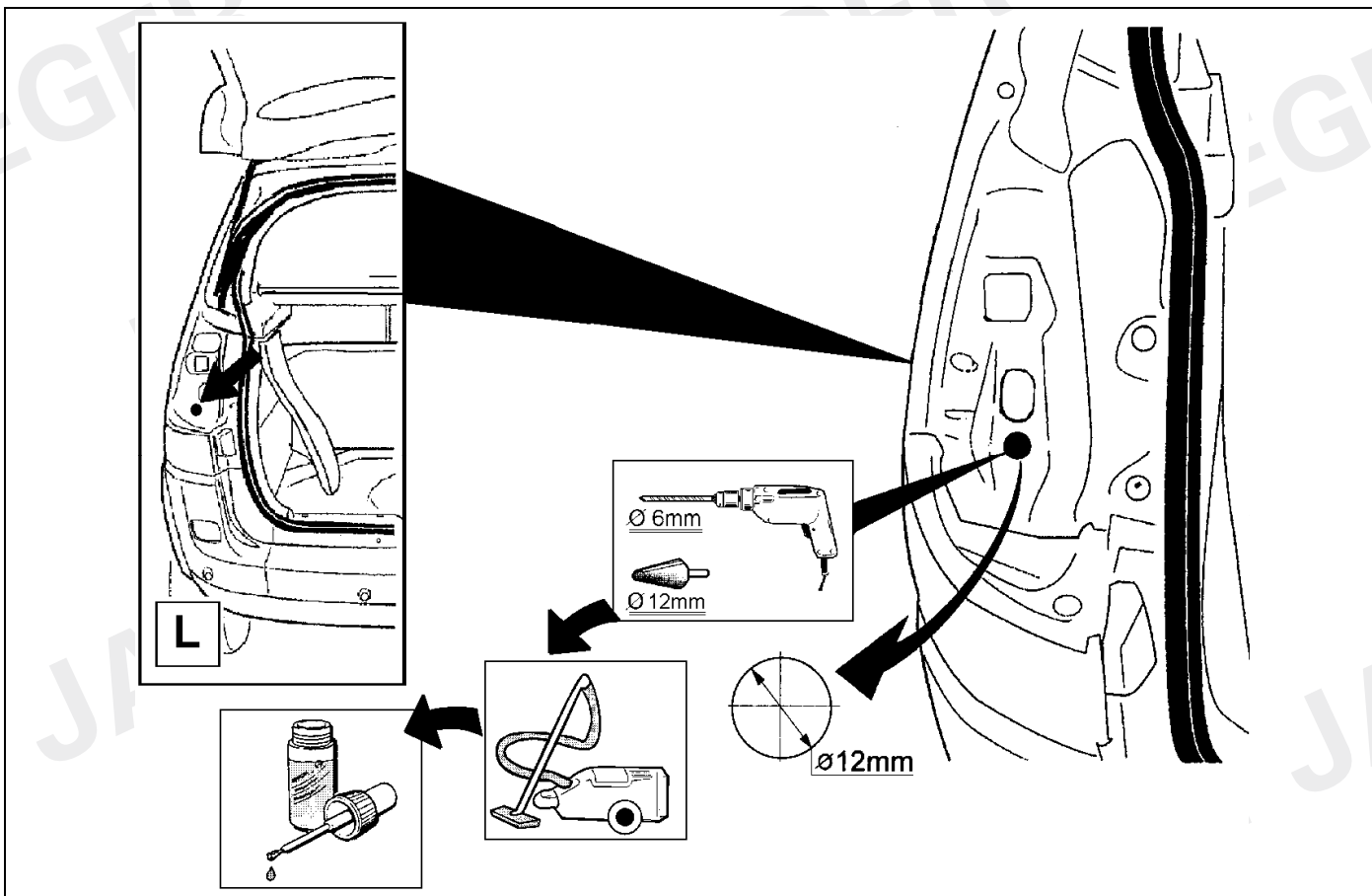



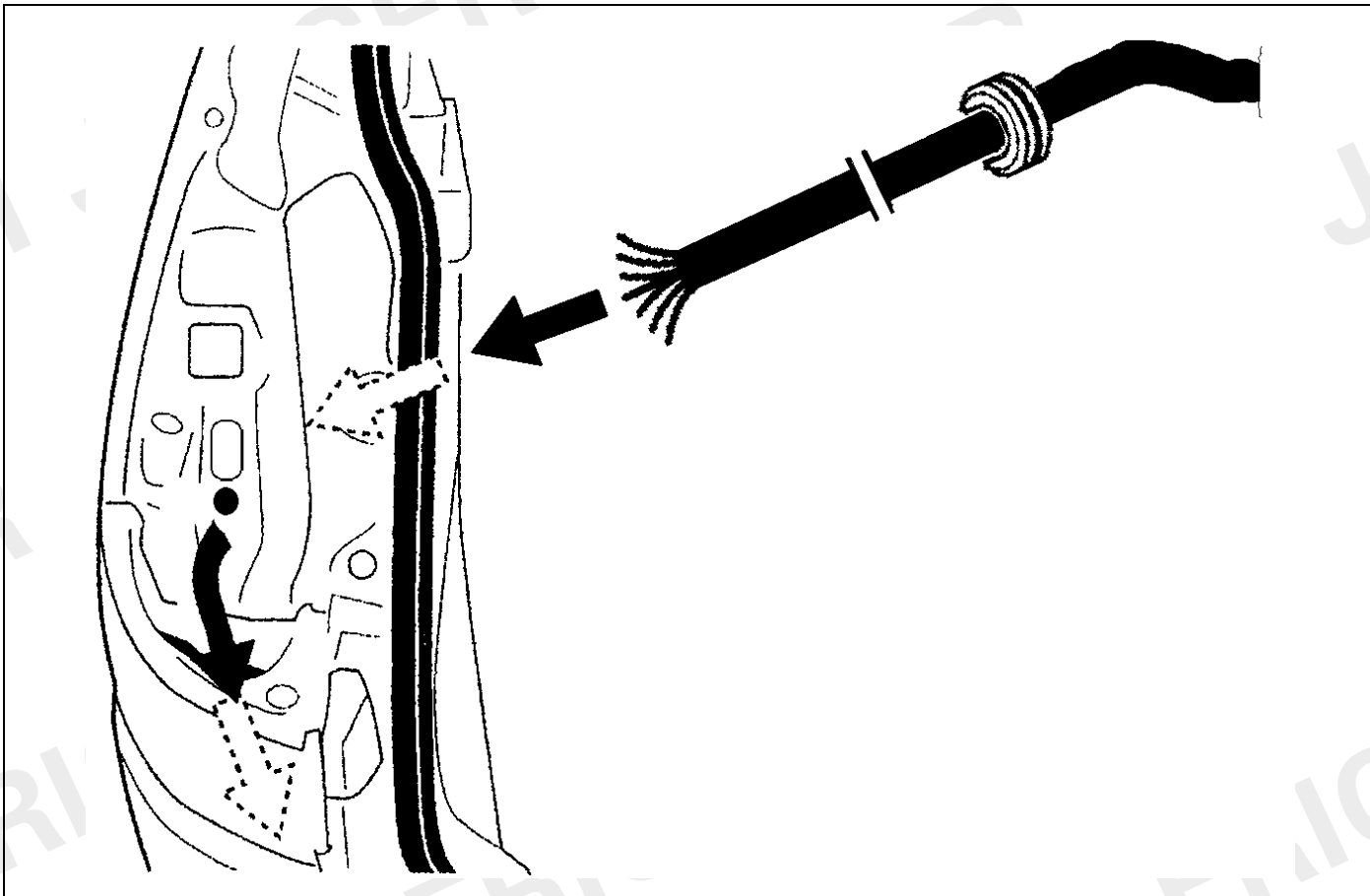



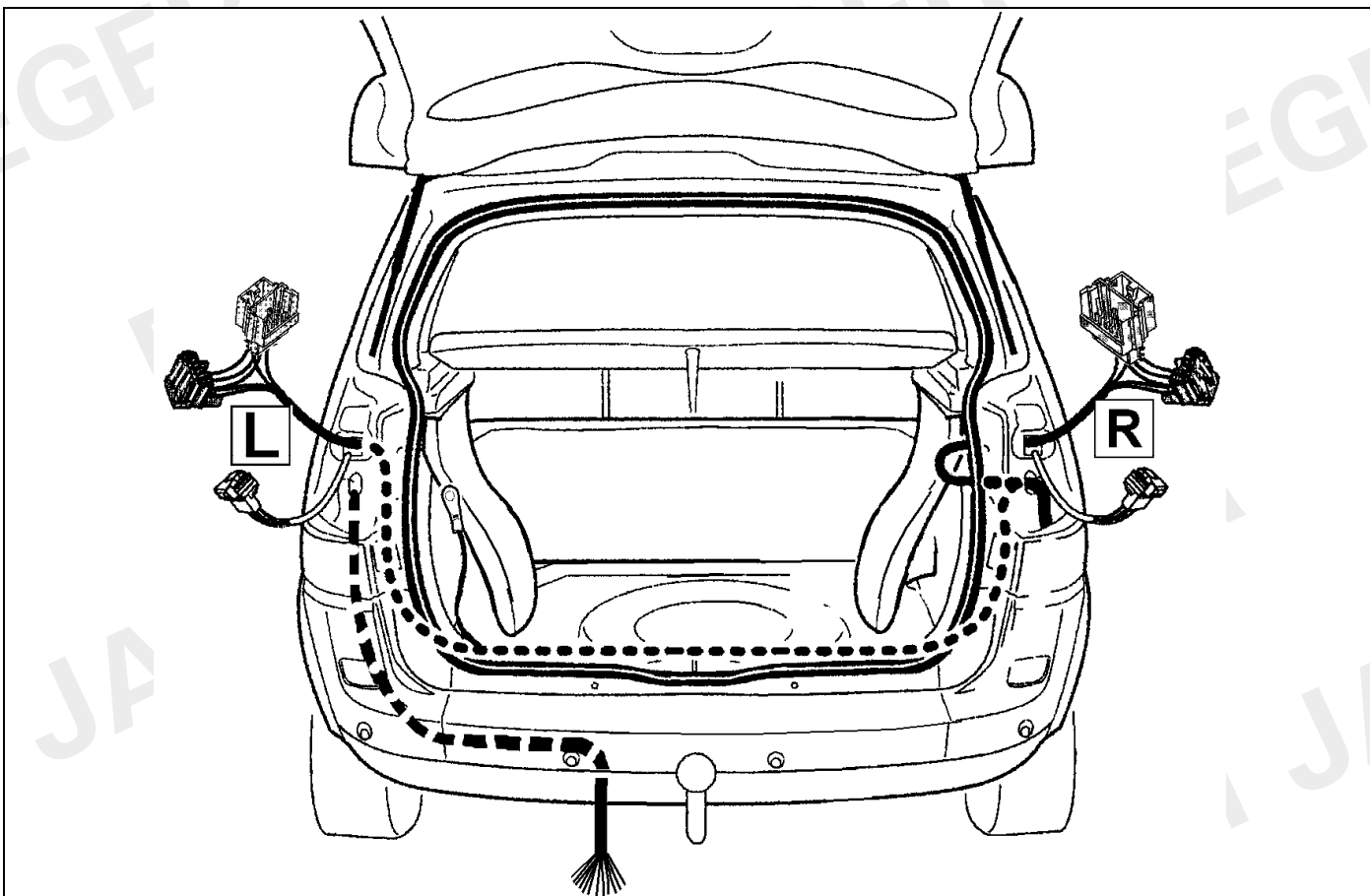

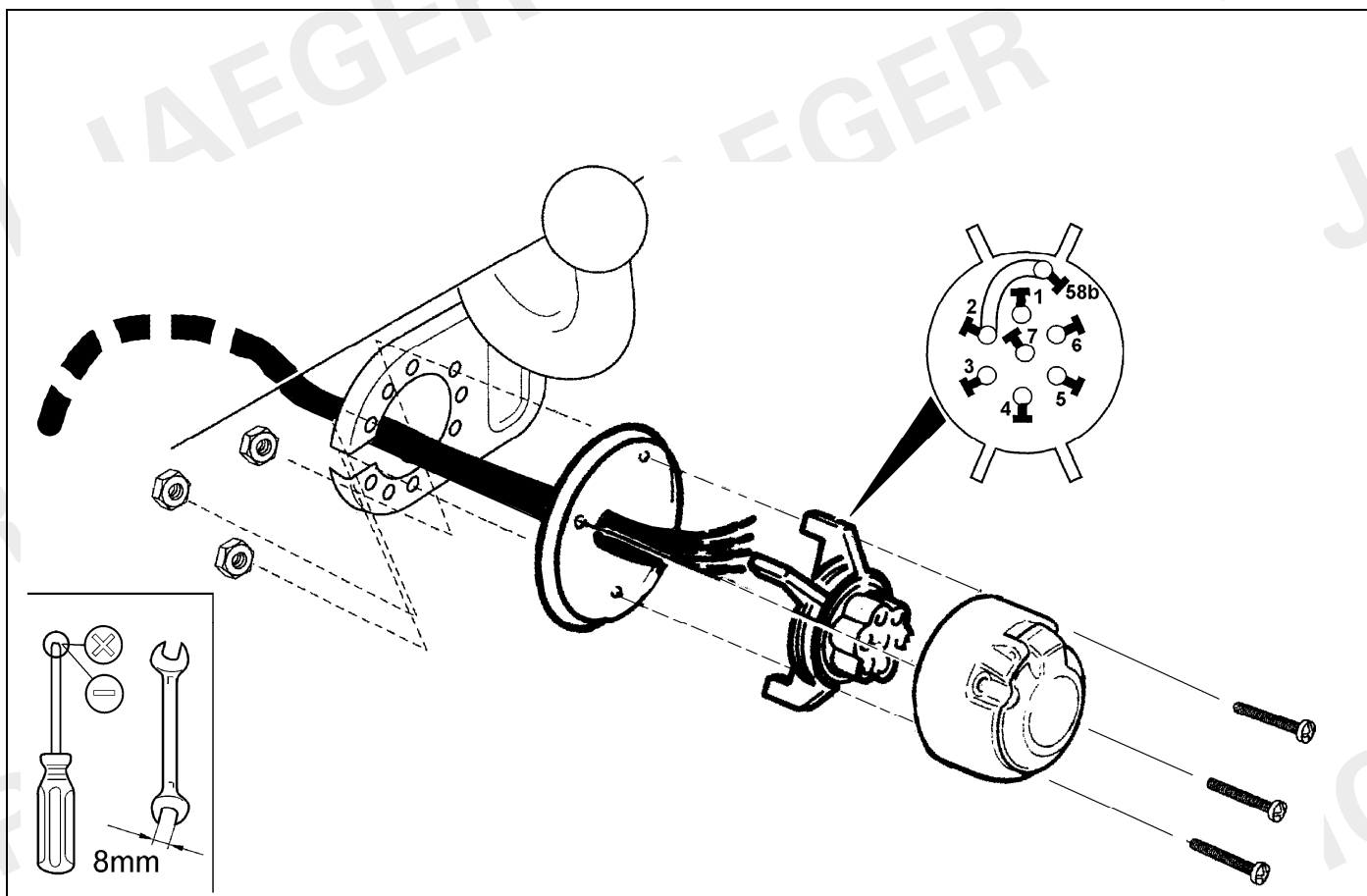







5



6





08									
									
									
1	gelb	yellow	jaune	amarillo	geel	amarelo	giallo	žluto	sárga
2	blau	blue	bleu	azul	blauw	azul	blu	modro	kék
3	weiß	white	blanc	blanco	wit	branco	bianco	bílý	fehér
4	grün	green	vert	verde	groen	verde	verde	zeleno	zöld
5	braun	brown	brun	marrón	bruin	castanho	marrone	hnědý	brana
6	rot	red	rouge	rojo	rood	vermelho	rosso	červený	piros
7	schwarz	black	noir	negro	zwart	preto	nero	černý	fekete
58b		blue/white	bleu/blanc	azul/blanco	blauw/wit	azul/branco	blu/bianco	modro/bílý	kék/fehér



9

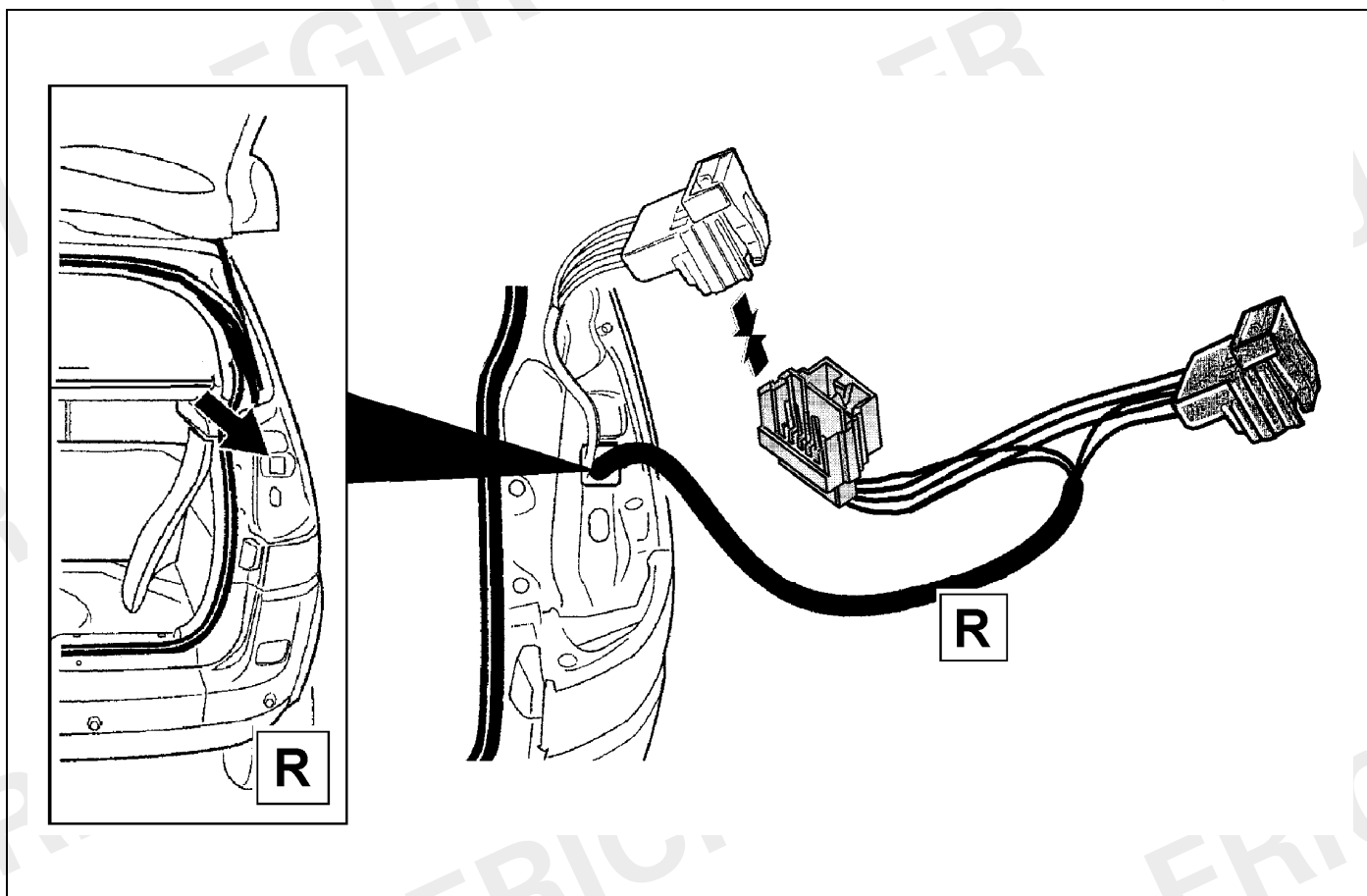

10

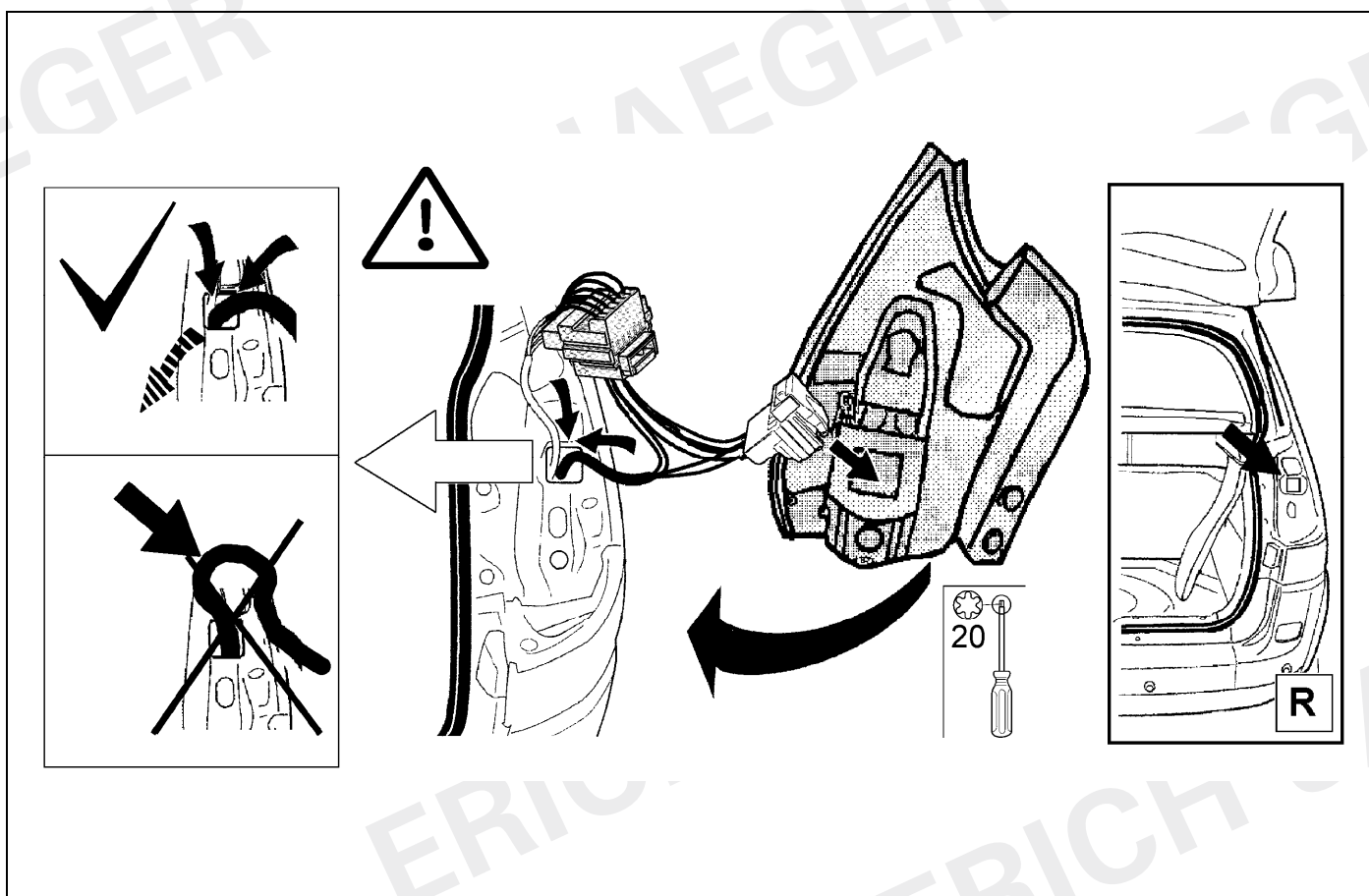



11

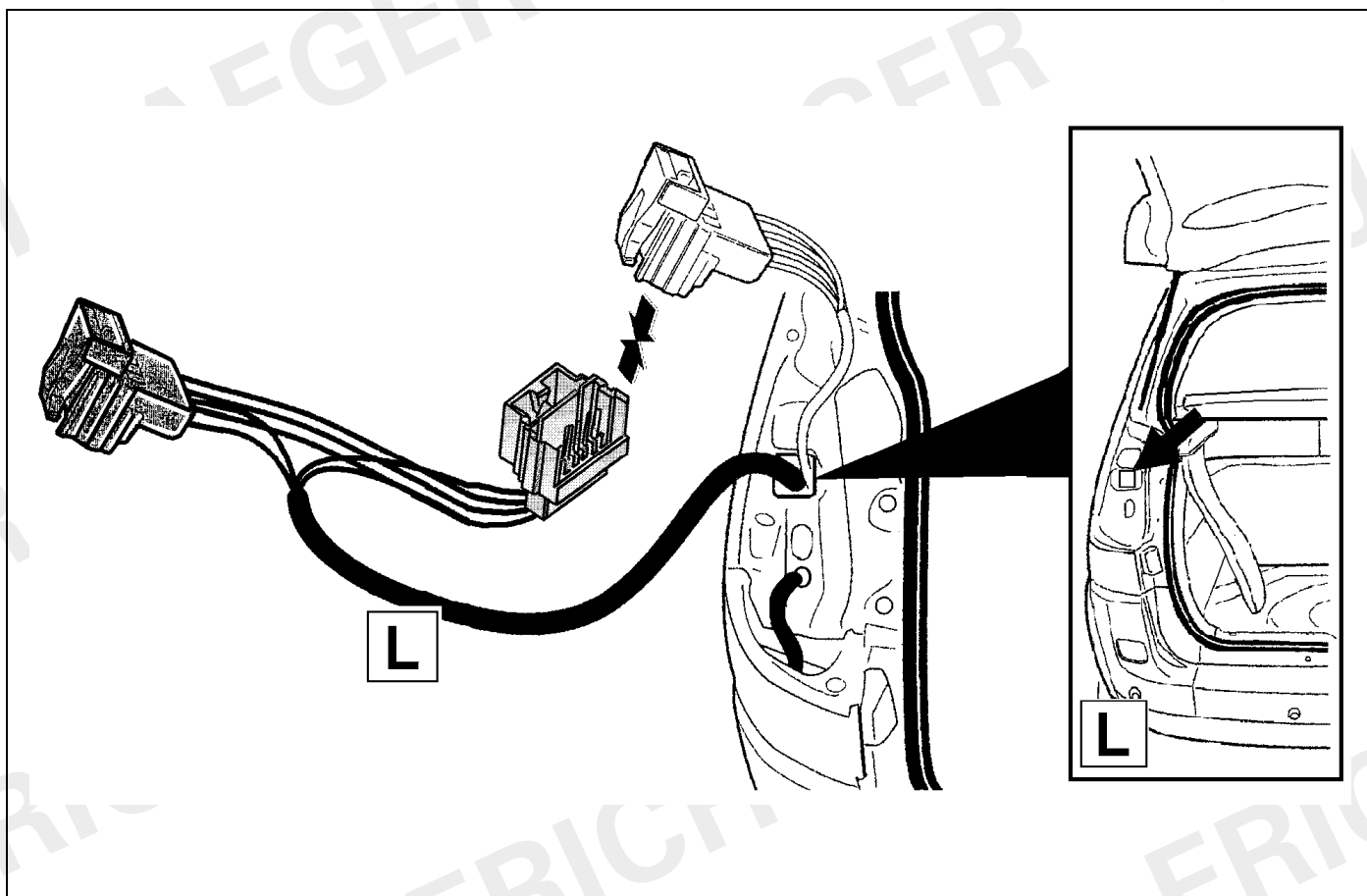

12

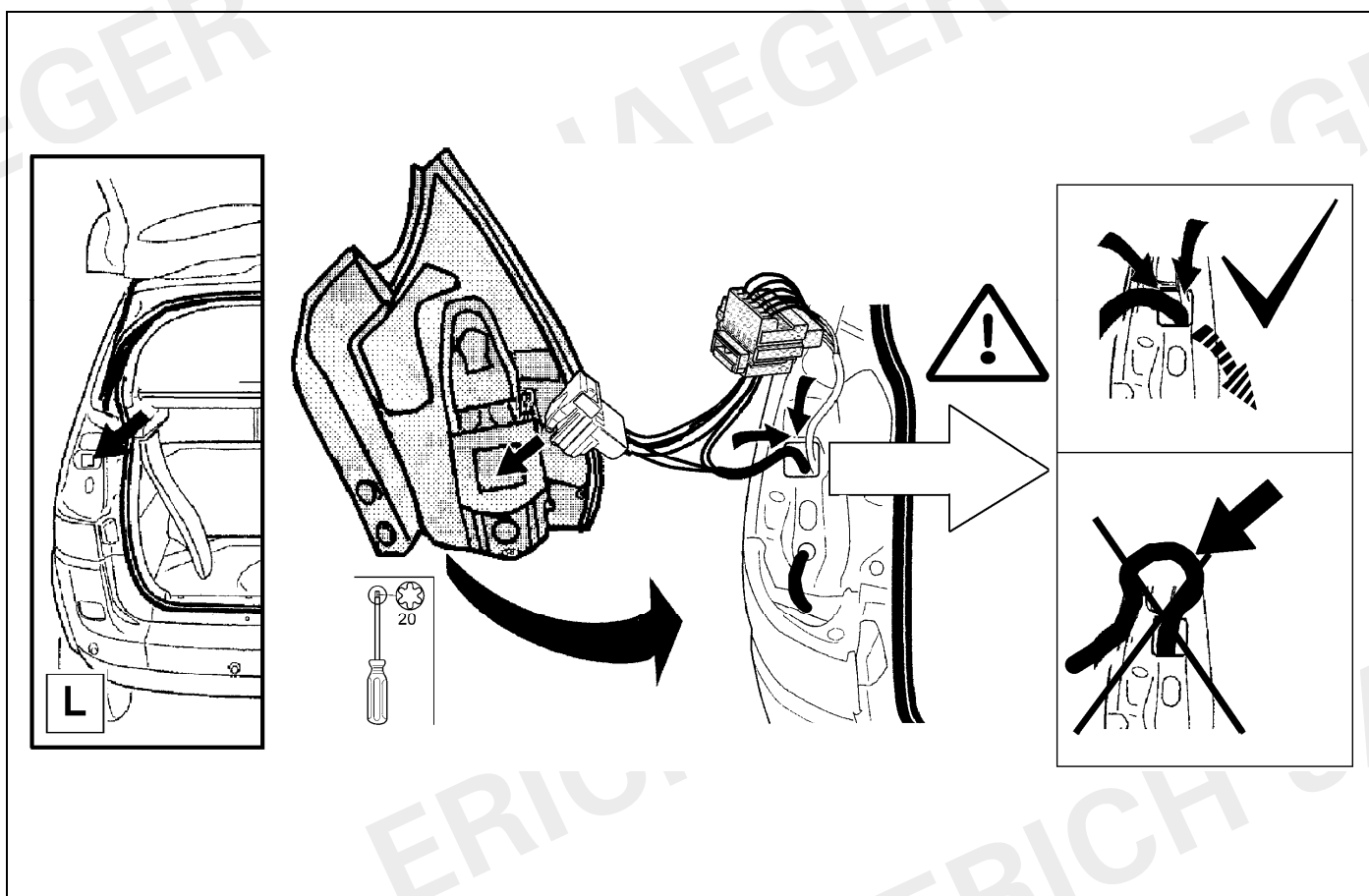

13

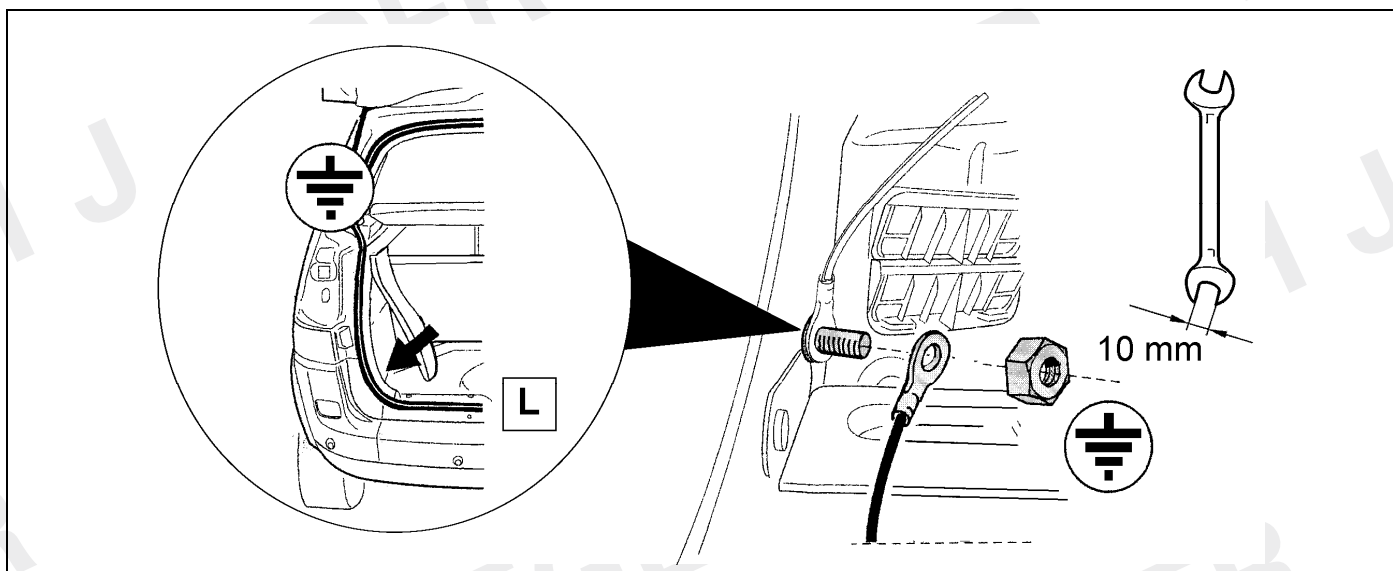

14

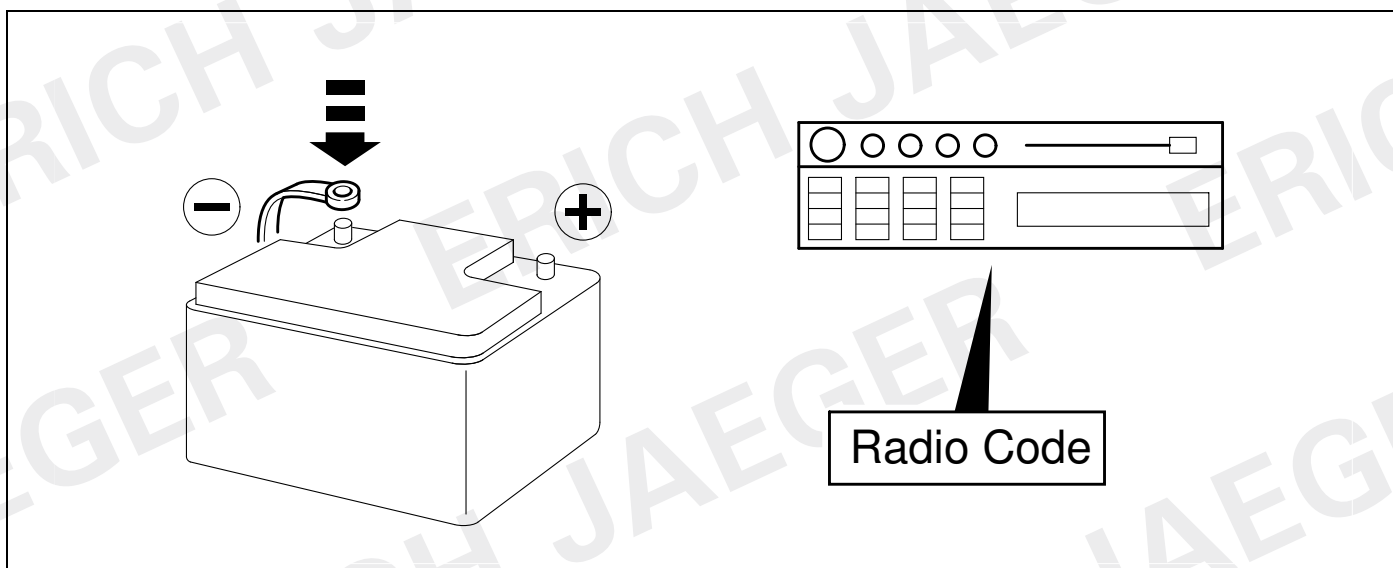

15

(D) Funktionen kontrollieren!

(GB) Check functions!

(F) Contrôler les fonctions!

(E) Compruebe las funciones!

(NL) Controleer functies!

(P) Verifique as funções!

(I) Controllare le funzioni!

(CZ) Zkontrolujte funkci!

(H) Ellenőrizze a funkciókat!

(PL) Sprawdź działanie!

(GR) Έλεγχος λειτουργίας!

(S) Kontrollera funktionerna!

(SLO) Preverite delovanje!

(TR) İşlevleri kontrol edin!

311069

311052

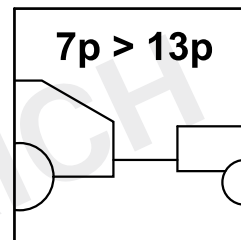
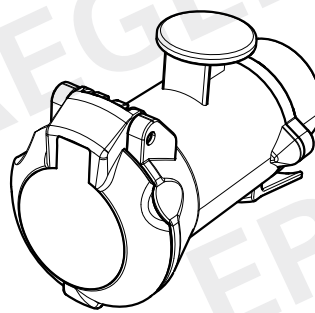
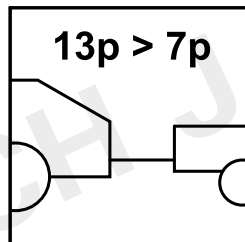
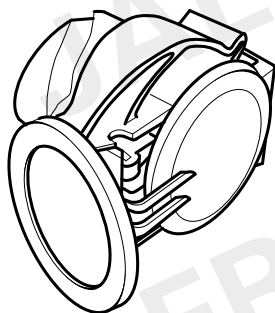

- |  |  |
|--|--|
| <b>(D)</b> Technische Änderungen vorbehalten!        | <b>(CZ)</b> Technická práva vyhrazena!                                   |
| <b>(GB)</b> Subject to change!                       | <b>(H)</b> Műszaki módosítások joga fenntartva!                          |
| <b>(F)</b> Sous réserve de modifications techniques! | <b>(PL)</b> Zastrzegamy sobie możliwość wprowadzenia zmian technicznych! |
| <b>(E)</b> Salvo modificaciones técnicas!            | <b>(GR)</b> ιατηρούμε το δικαίωμα των τεχνικών αλλαγών!                  |
| <b>(NL)</b> Technische wijzigingen voorbehouden!     | <b>(S)</b> Ändringar förbehålls!   |
| <b>(P)</b> Sujeito a modificações técnicas!          | <b>(SLO)</b> Pravice do sprememb pridržane!                              |
| <b>(I)</b> Salvo modificaciones técnicas!            | <b>(TR)</b> Teknik değişiklikler mahfuzdur!                              |