

7P / 12V SAE J560 Dose dicht

501109; 501151; 501152; 501157; 501153; 501156; 501154; 501158

7P / 12V SAE J560 Sealed Socket

501186; 501187; 501188; 501189; 501190; 501191; 501192; 501193

- | | |
|---------------------------------|--|
| (D) Einbauanleitung | (PL) Instrukcja montażu |
| (GB) Installation instructions | (TR) Montaj talimatı |
| (F) Consignes de montage | (H) Beépítési útmutató |
| (NL) Montagehandleiding | (HR) Upute o ugradnji |
| (DK) Montagevejledning | (BUL) Инструкция за монтаж |
| (N) Monteringsinstruksjon | (RO) Instrucțiuni de montaj |
| (S) Installationsanvisning | (RU) Инструкция по монтажу и установке |
| (FIN) Asennusohje | (LT) Montavimo informacija |
| (I) Istruzioni per il montaggio | (LV) Iemontēšanas pamācība |
| (E) Instrucciones de montaje | (EST) Paigaldusjuhend |
| (P) Instruções de montagem | (SLO) Navodilo za vgradnjo |
| (GR) Οδηγίες εγκατάστασης | (SK) Montážny návod |
| (CZ) Návod k montáži | (CN) 说明书 |



KIT

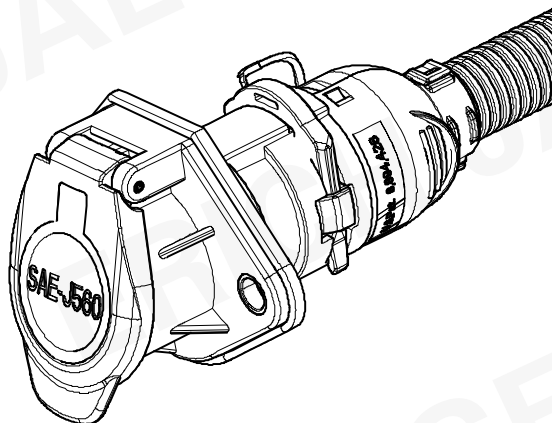

**501109; 501151
501152; 501156**

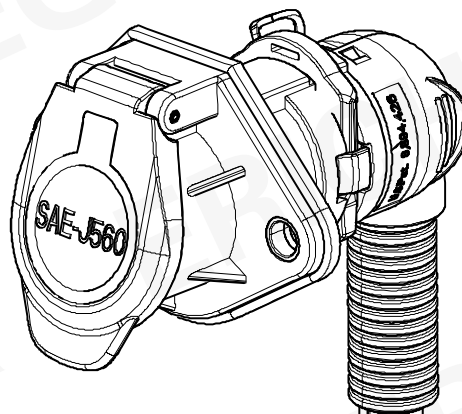

**501186; 501187
501188; 501189**

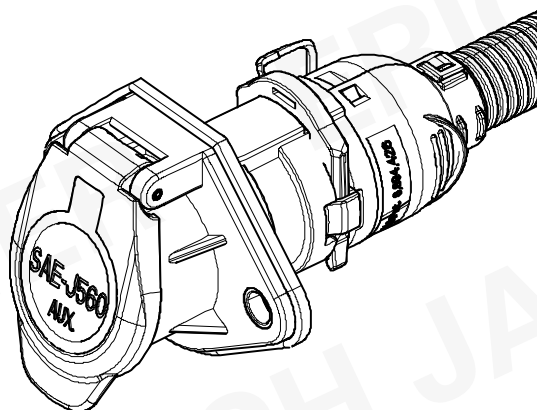

**501153; 501156
501154; 501158**

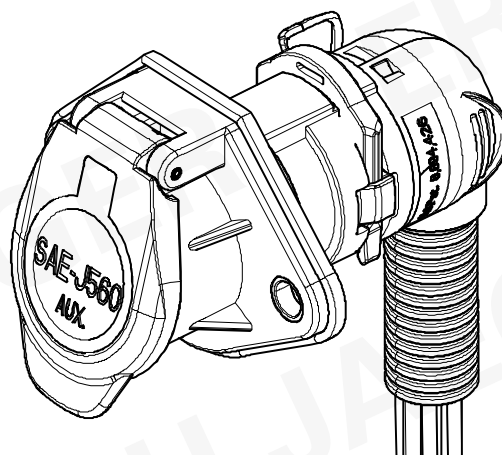

**501190; 501191
501192; 501193**

TOOLS

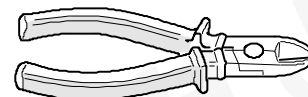
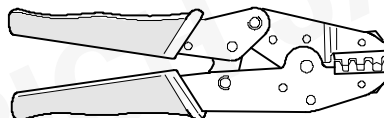
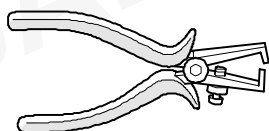

1

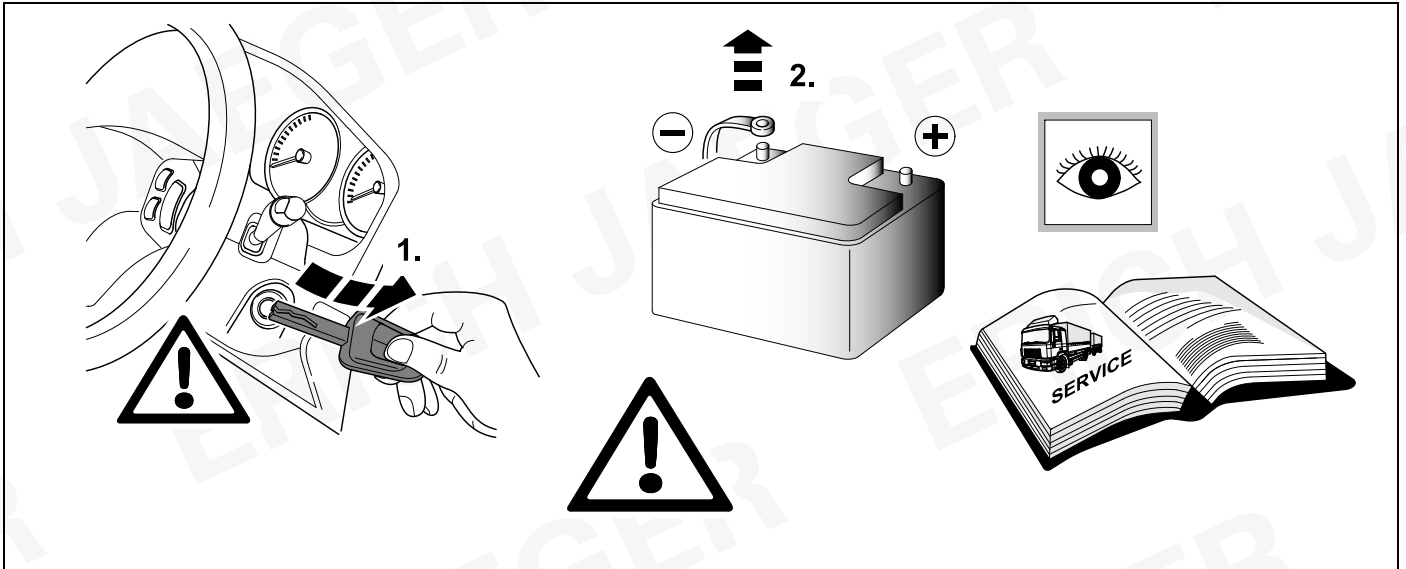

2

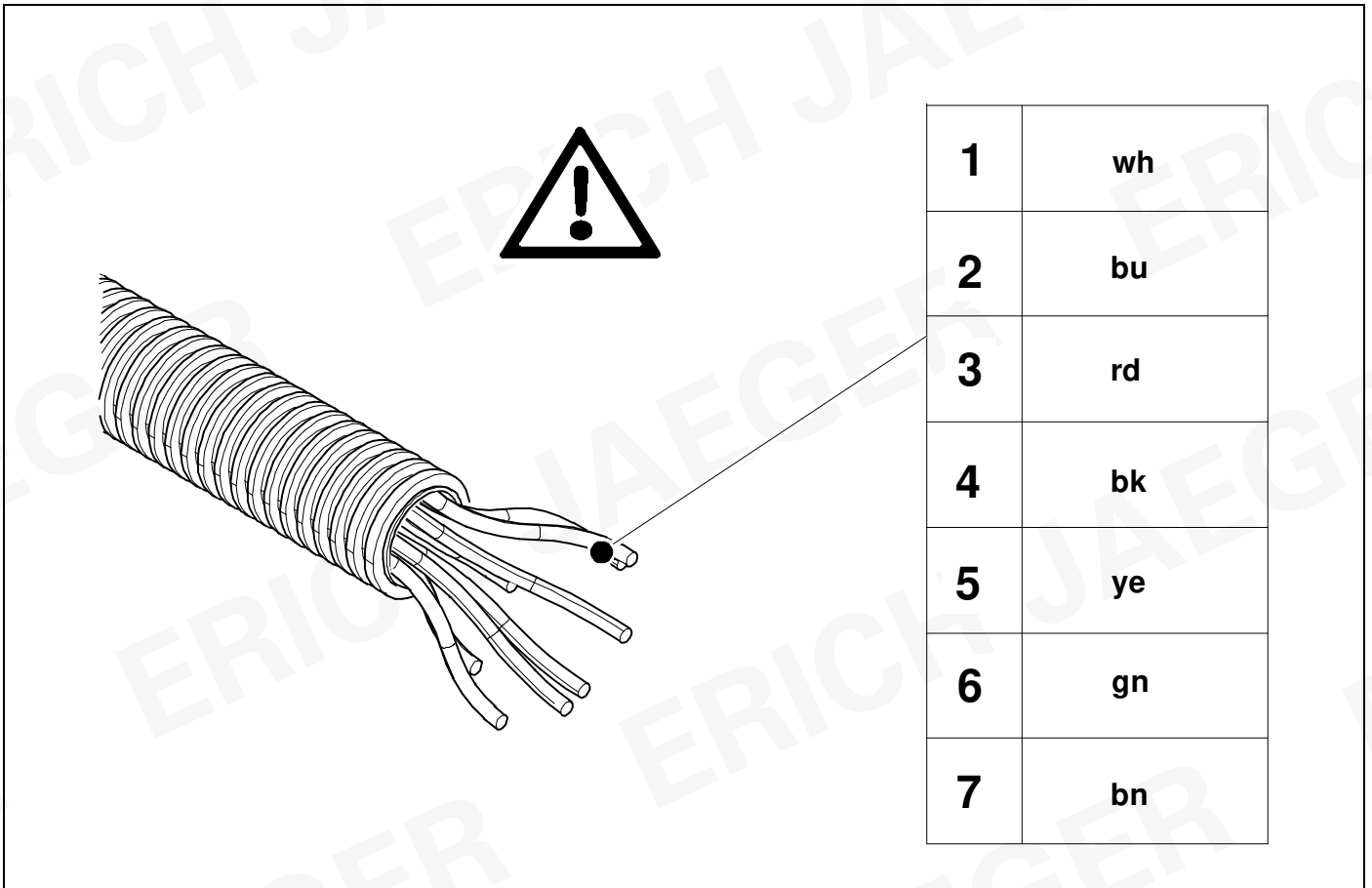

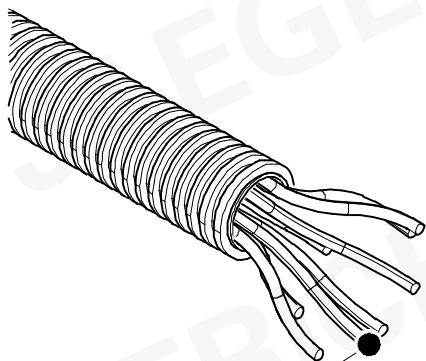
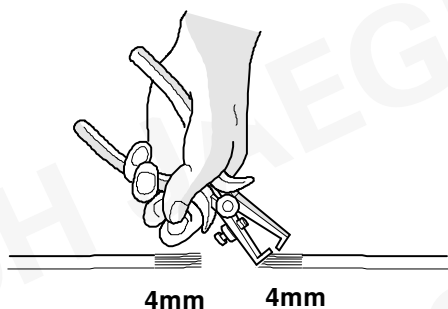
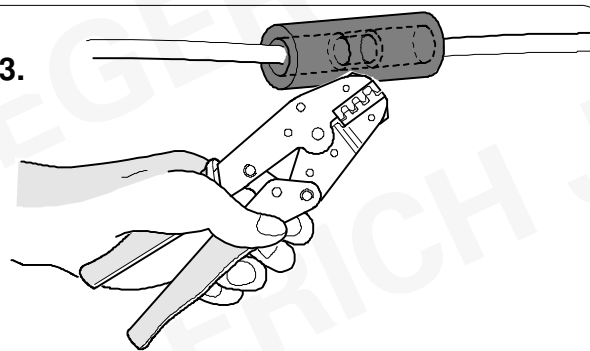
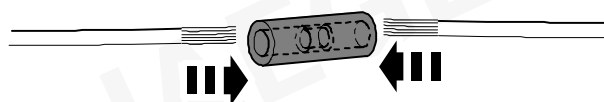
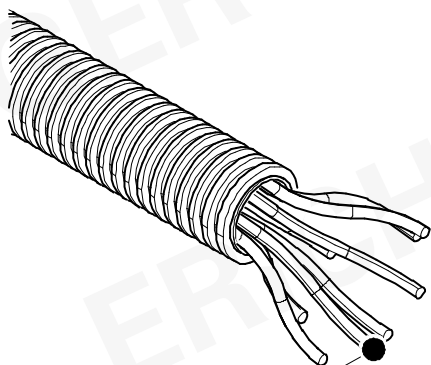
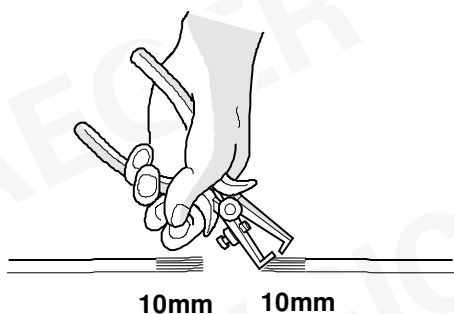
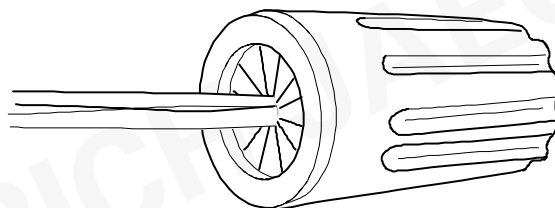
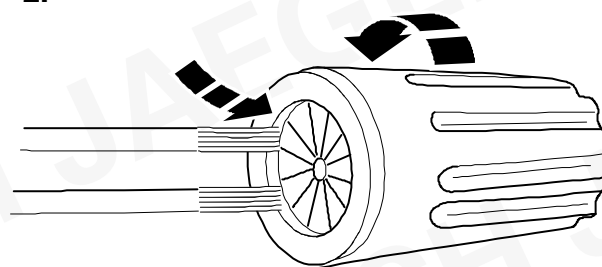
3**Option 1****1.****3.****2.****4****Option 2****1.****3.****2.**

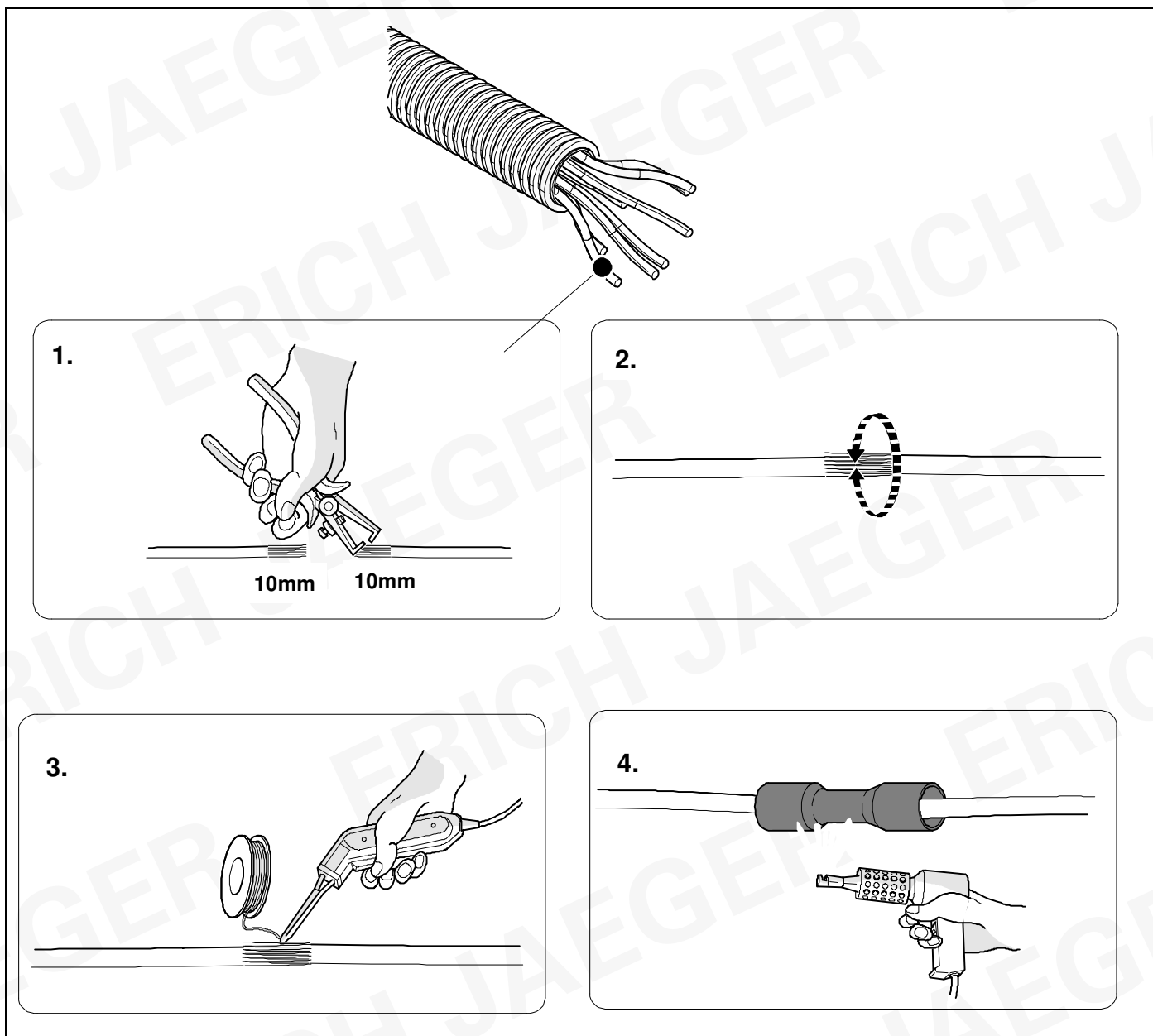

6	Contact allocation 7P Primary SAE J650	
Contact cavity no.	Wire colour	Function
1	wh	Ground return to towing vehicle
2	bk	Clearance, side marker and identification lamps
3	ye	Left turn signal and hazard lamps
4	rd	Stop lamps and Antilock Braking System (ABS) (Secondary Power)
5	gn	Right turn signal and hazard lamps
6	bn	Tail and license plate, clearance and and/or side marker lamps
7	bu	Continuous ABS primary power/auxiliary devices

7	Contact allocation 7P Auxiliary SAE J650	
Contact cavity no.	Wire colour	Function
1	wh	Ground return to towing vehicle
2	bk	Cab switches auxiliary power
3	ye	ABS malfunction signal to cab
4	rd	Constant or ignition power
5	gn	Unassigned
6	bn	Unassigned
7	bu	Unassigned

8

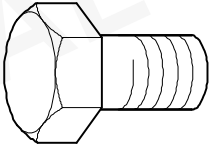
15 Nm (± 2 Nm)

M8

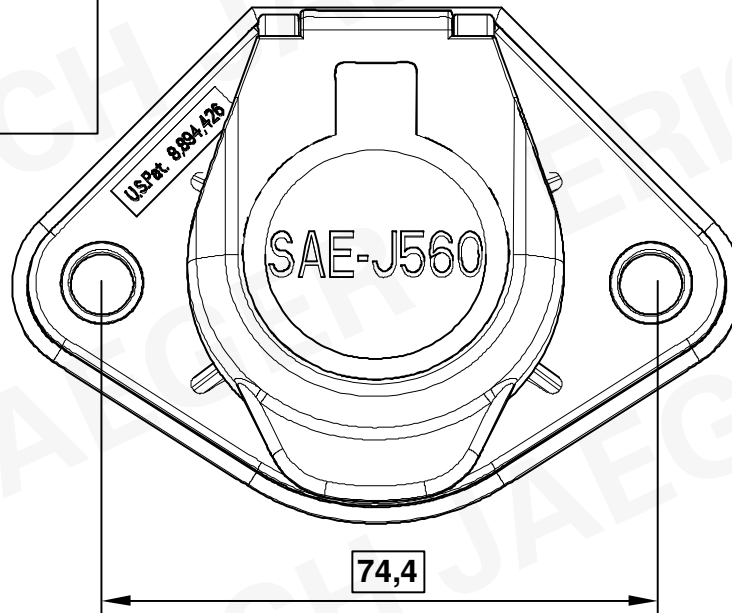

9

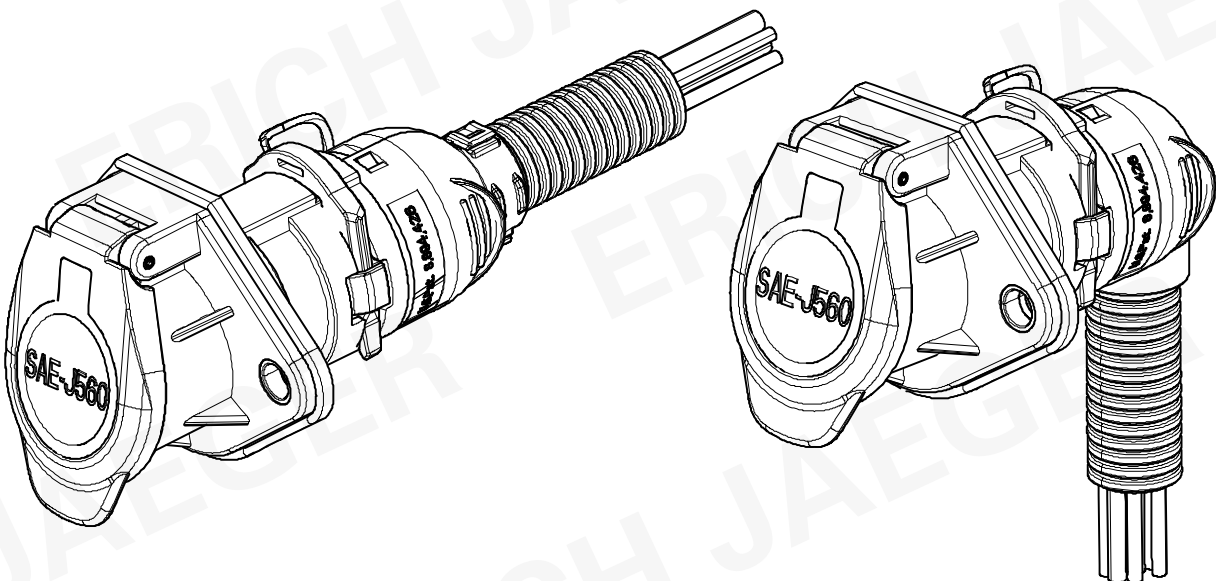

10

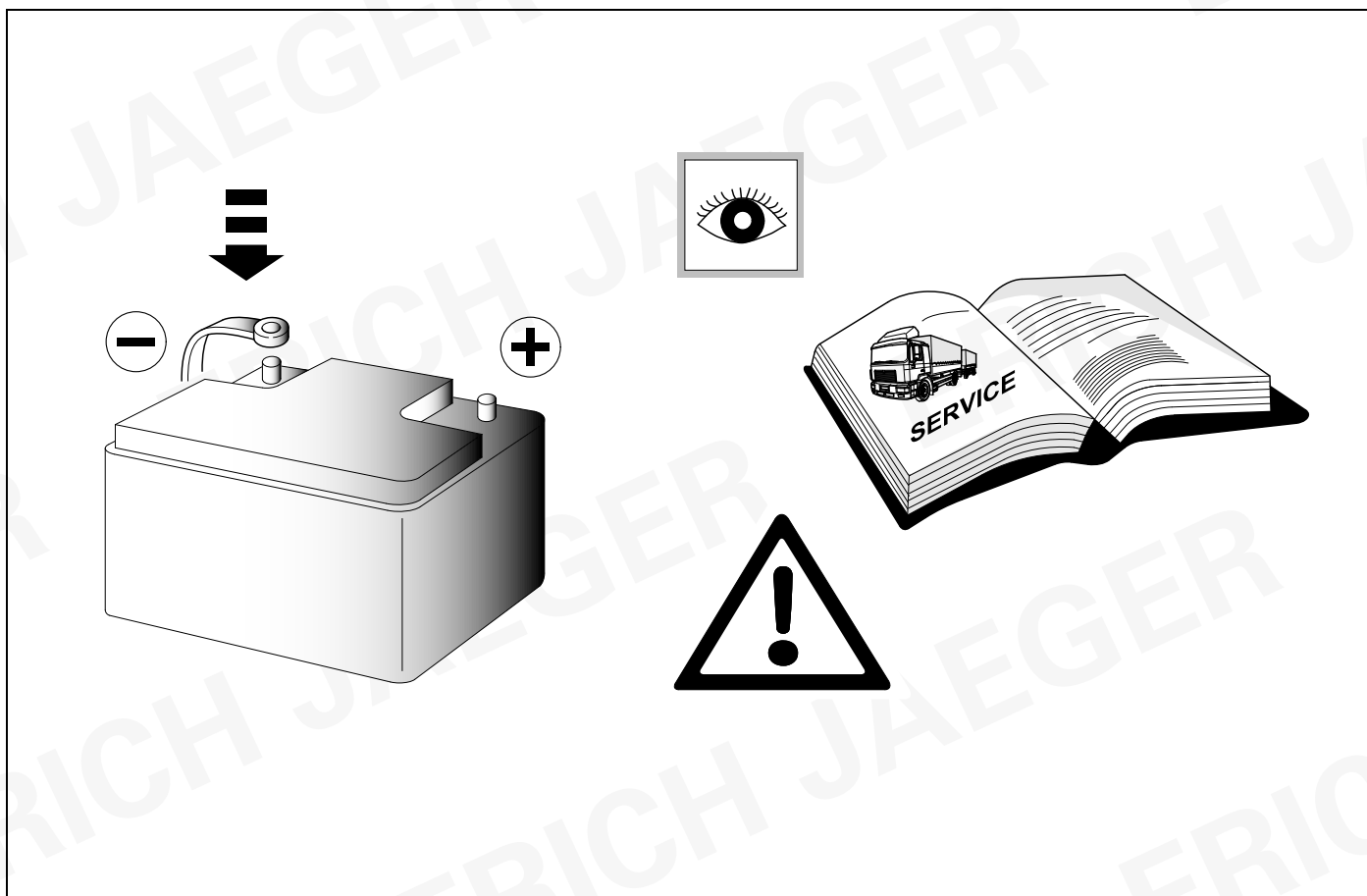

11 CHECK

