

## 7P / 12V SAE J560 Dose dicht

501109; 501151; 501152; 501157; 501153; 501156; 501154; 501158

## 7P / 12V SAE J560 Sealed Socket

501186; 501187; 501188; 501189; 501190; 501191; 501192; 501193

- |                                 |  |
|---------------------------------|--|
| (D) Einbauanleitung             | (PL) Instrukcja montażu                |
| (GB) Installation instructions  | (TR) Montaj talimatı                   |
| (F) Consignes de montage        | (H) Beépítési útmutató                 |
| (NL) Montagehandleiding         | (HR) Upute o ugradnji                  |
| (DK) Montagevejledning          | (BUL) Инструкция за монтаж             |
| (N) Monteringsinstruksjon       | (RO) Instrucțiuni de montaj            |
| (S) Installationsanvisning      | (RU) Инструкция по монтажу и установке |
| (FIN) Asennusohje               | (LT) Montavimo informacija             |
| (I) Istruzioni per il montaggio | (LV) Iemontēšanas pamācība             |
| (E) Instrucciones de montaje    | (EST) Paigaldusjuhend                  |
| (P) Instruções de montagem      | (SLO) Navodilo za vgradnjo             |
| (GR) Οδηγίες εγκατάστασης       | (SK) Montážny návod                    |
| (CZ) Návod k montáži            | (CN) 说明书                               |



## KIT

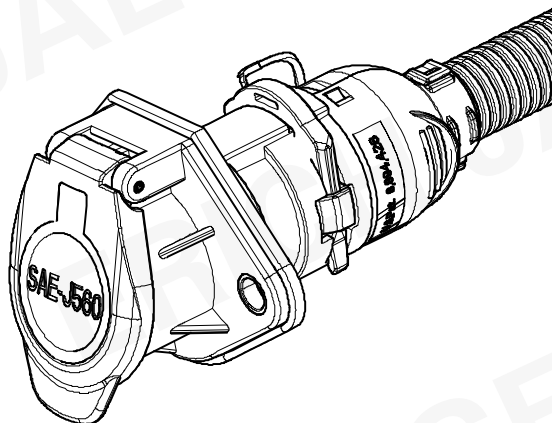

**501109; 501151  
501152; 501156**

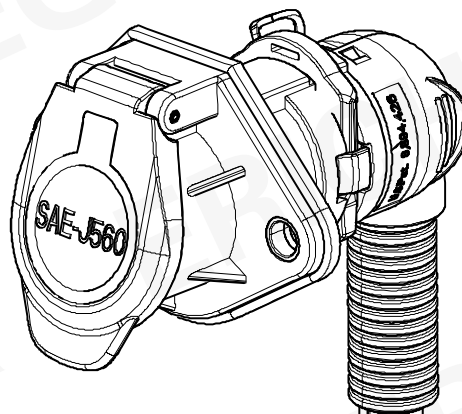

**501186; 501187  
501188; 501189**

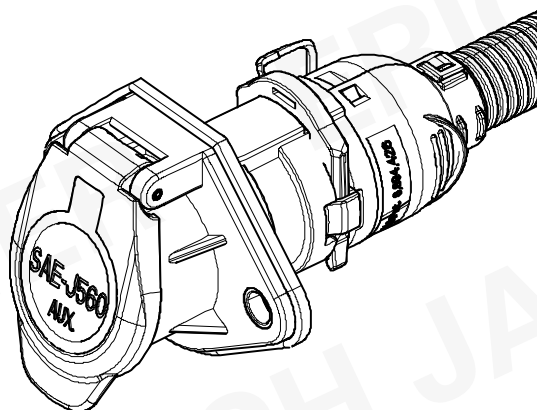

**501153; 501156  
501154; 501158**

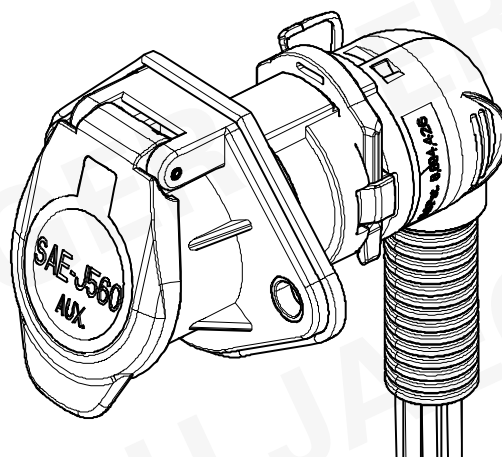

**501190; 501191  
501192; 501193**

## TOOLS

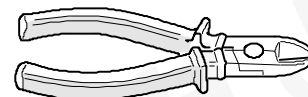
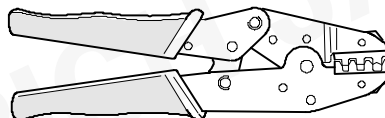
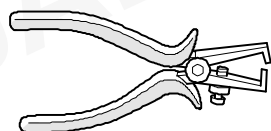

1

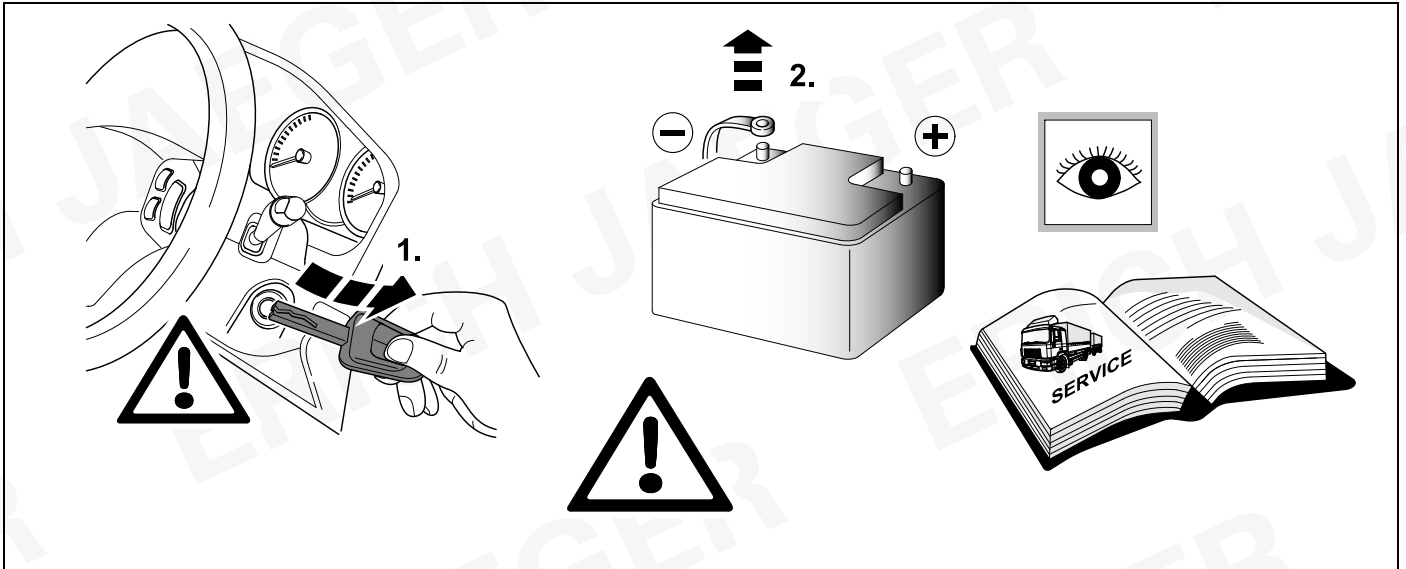

2

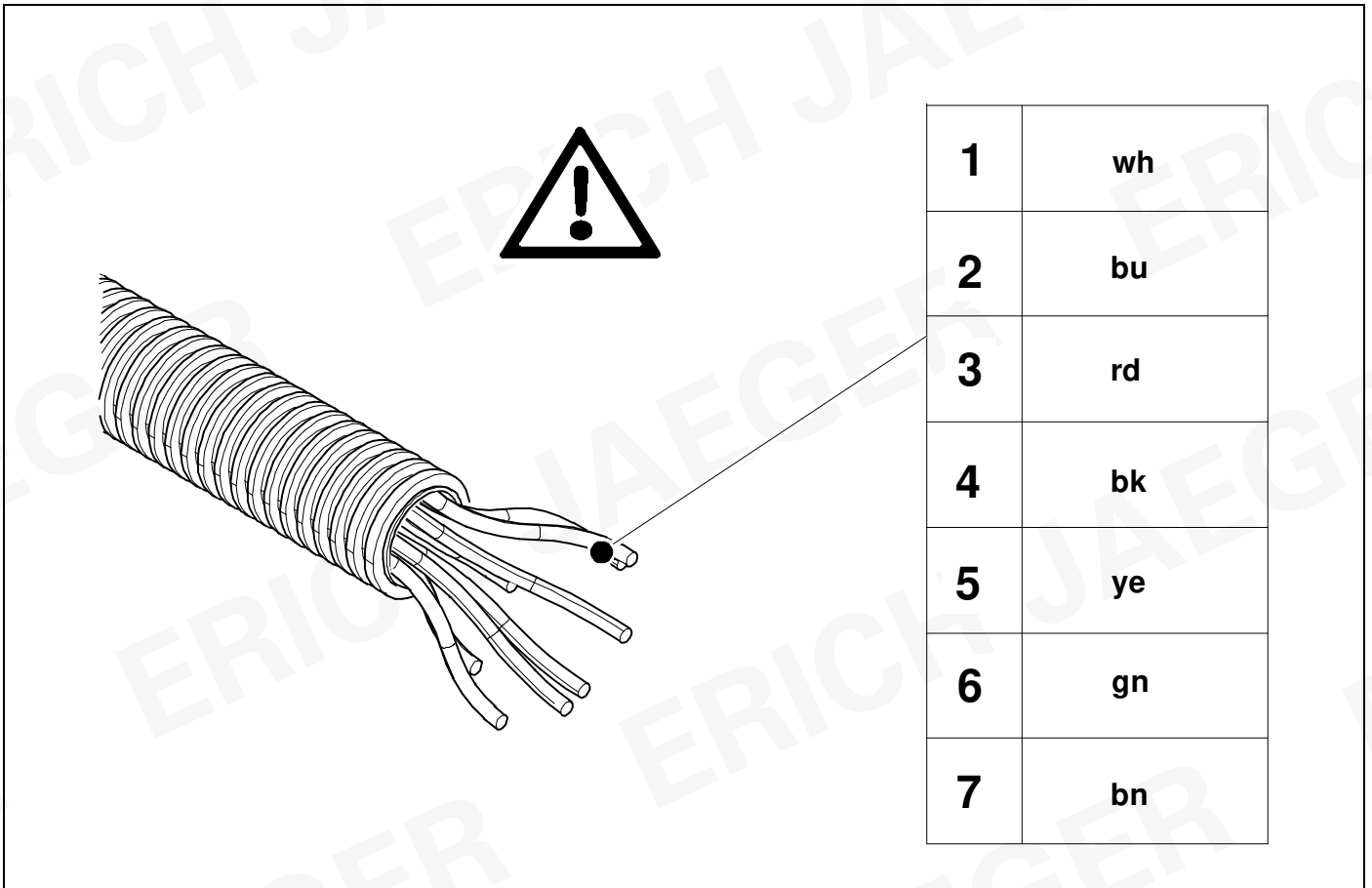

3

## Option 1

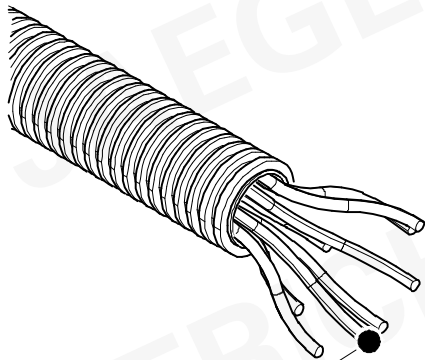

1.

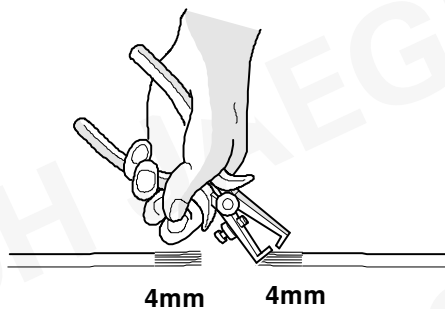

3.

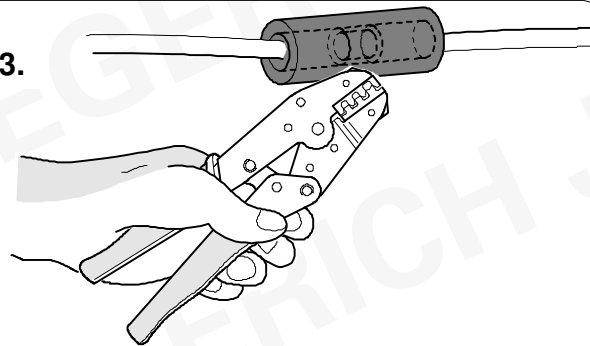

2.

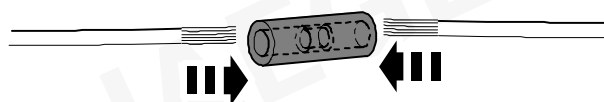

4

## Option 2

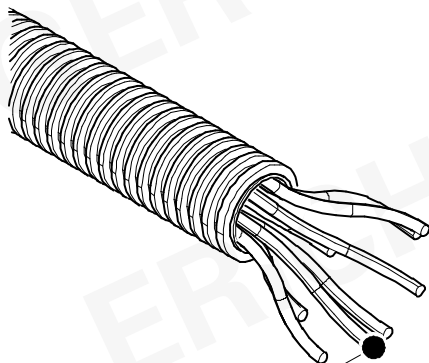

1.

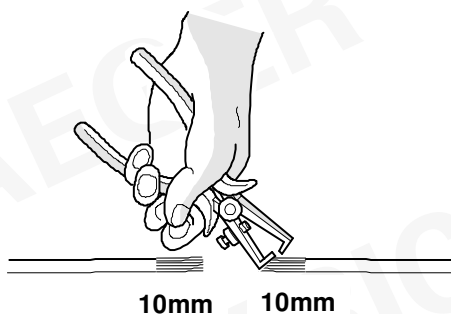

3.

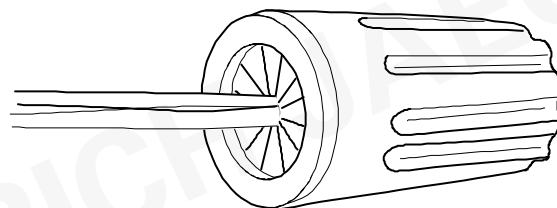

2.

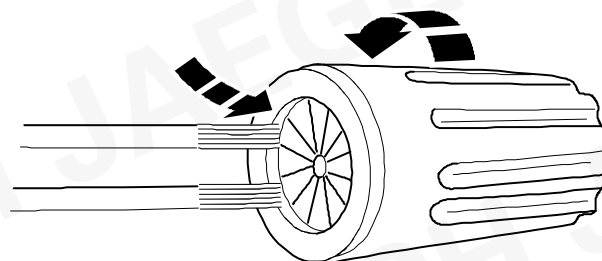

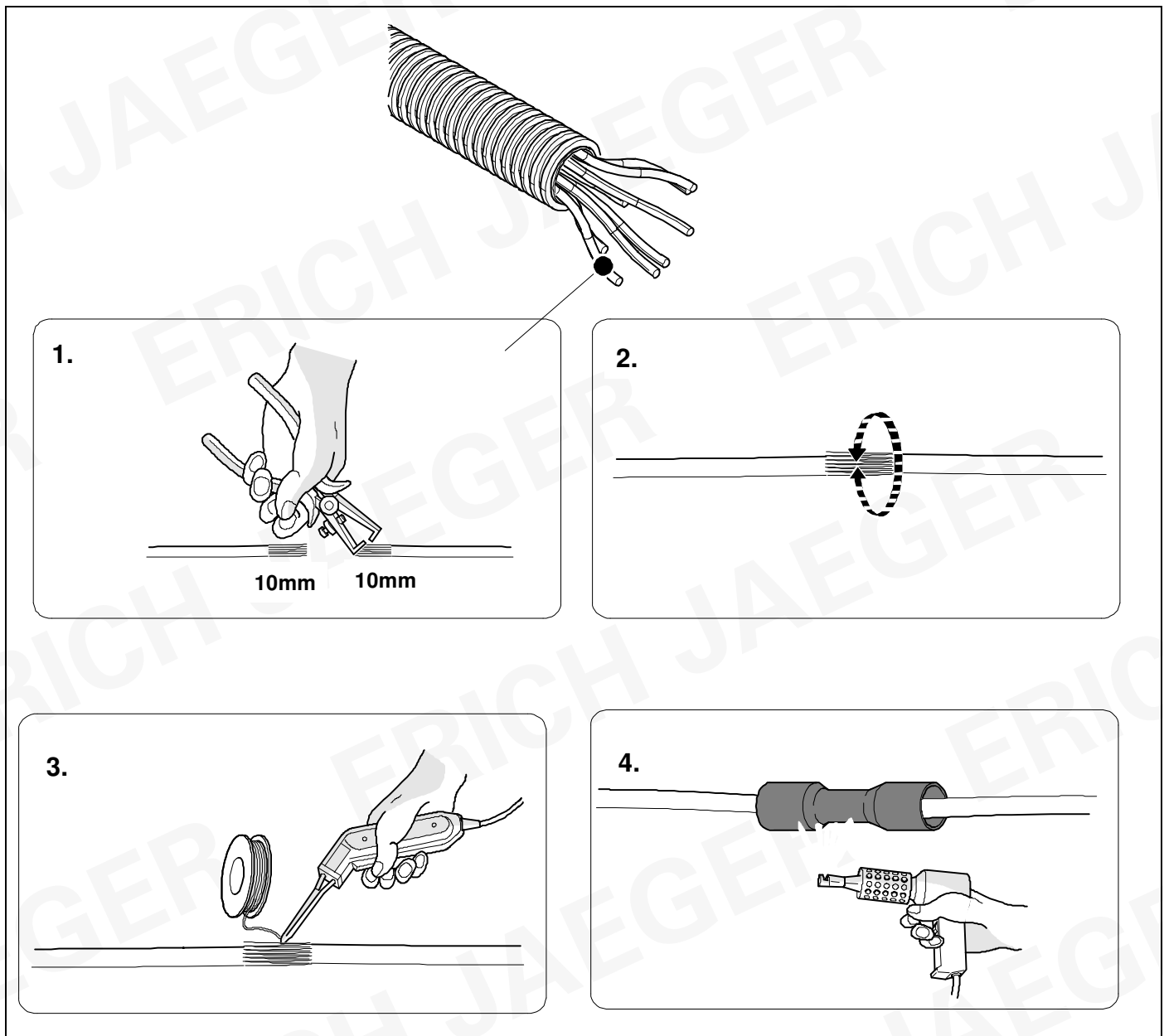

<b>6</b>	<b>Contact allocation 7P Primary SAE J650</b>	
Contact cavity no.	Wire colour	Function
<b>1</b>	<b>wh</b>	<b>Ground return to towing vehicle</b>
<b>2</b>	<b>bk</b>	<b>Clearance, side marker and identification lamps</b>
<b>3</b>	<b>ye</b>	<b>Left turn signal and hazard lamps</b>
<b>4</b>	<b>rd</b>	<b>Stop lamps and Antilock Braking System (ABS) (Secondary Power)</b>
<b>5</b>	<b>gn</b>	<b>Right turn signal and hazard lamps</b>
<b>6</b>	<b>bn</b>	<b>Tail and license plate, clearance and and/or side marker lamps</b>
<b>7</b>	<b>bu</b>	<b>Continuous ABS primary power/auxiliary devices</b>

<b>7</b>	<b>Contact allocation 7P Auxiliary SAE J650</b>	
Contact cavity no.	Wire colour	Function
<b>1</b>	<b>wh</b>	<b>Ground return to towing vehicle</b>
<b>2</b>	<b>bk</b>	<b>Cab switches auxiliary power</b>
<b>3</b>	<b>ye</b>	<b>ABS malfunction signal to cab</b>
<b>4</b>	<b>rd</b>	<b>Constants or ignition power</b>
<b>5</b>	<b>gn</b>	<b>Unassigned</b>
<b>6</b>	<b>bn</b>	<b>Unassigned</b>
<b>7</b>	<b>bu</b>	<b>Unassigned</b>

8

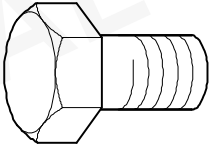
15 Nm ( $\pm 2$ Nm)

M8

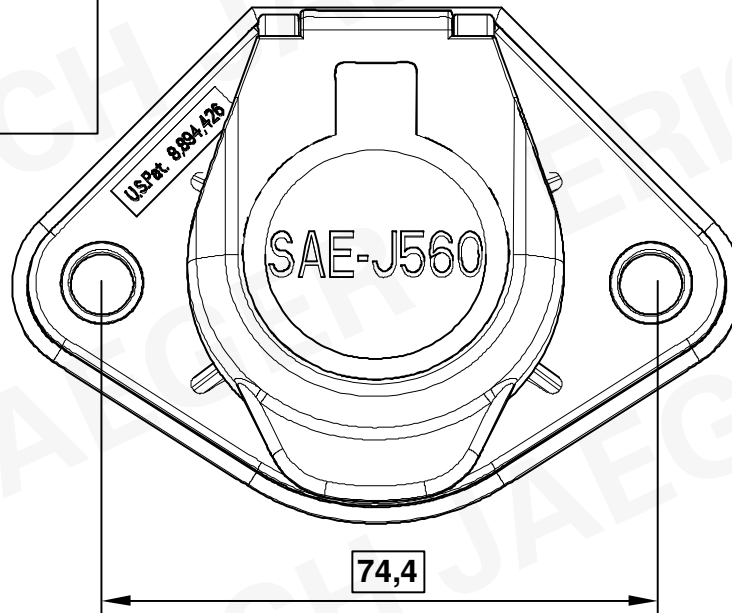

9

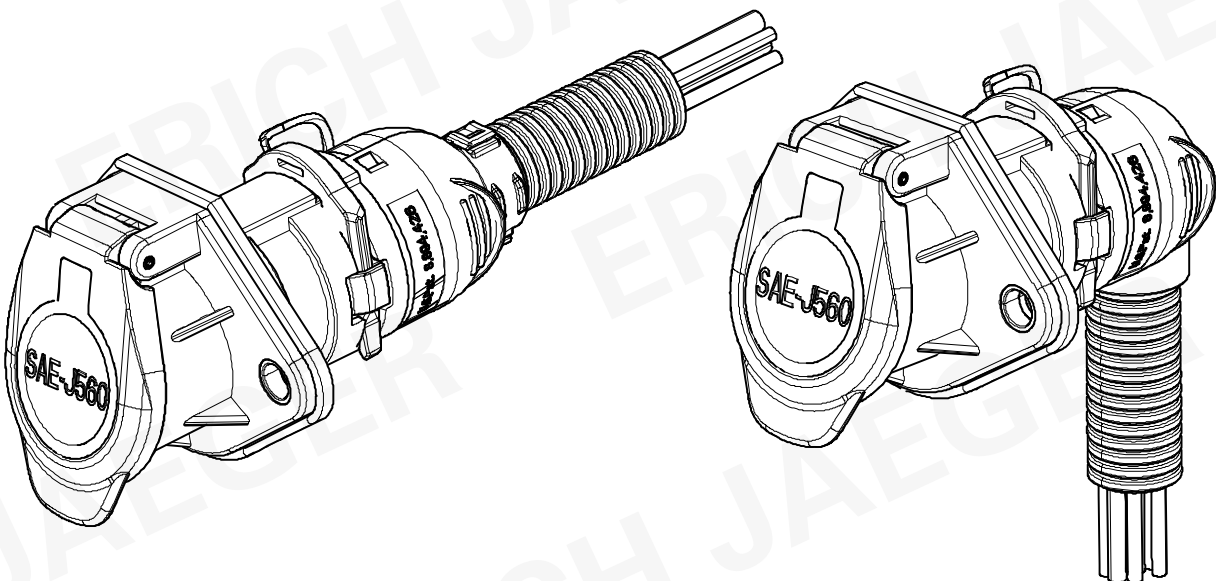

10

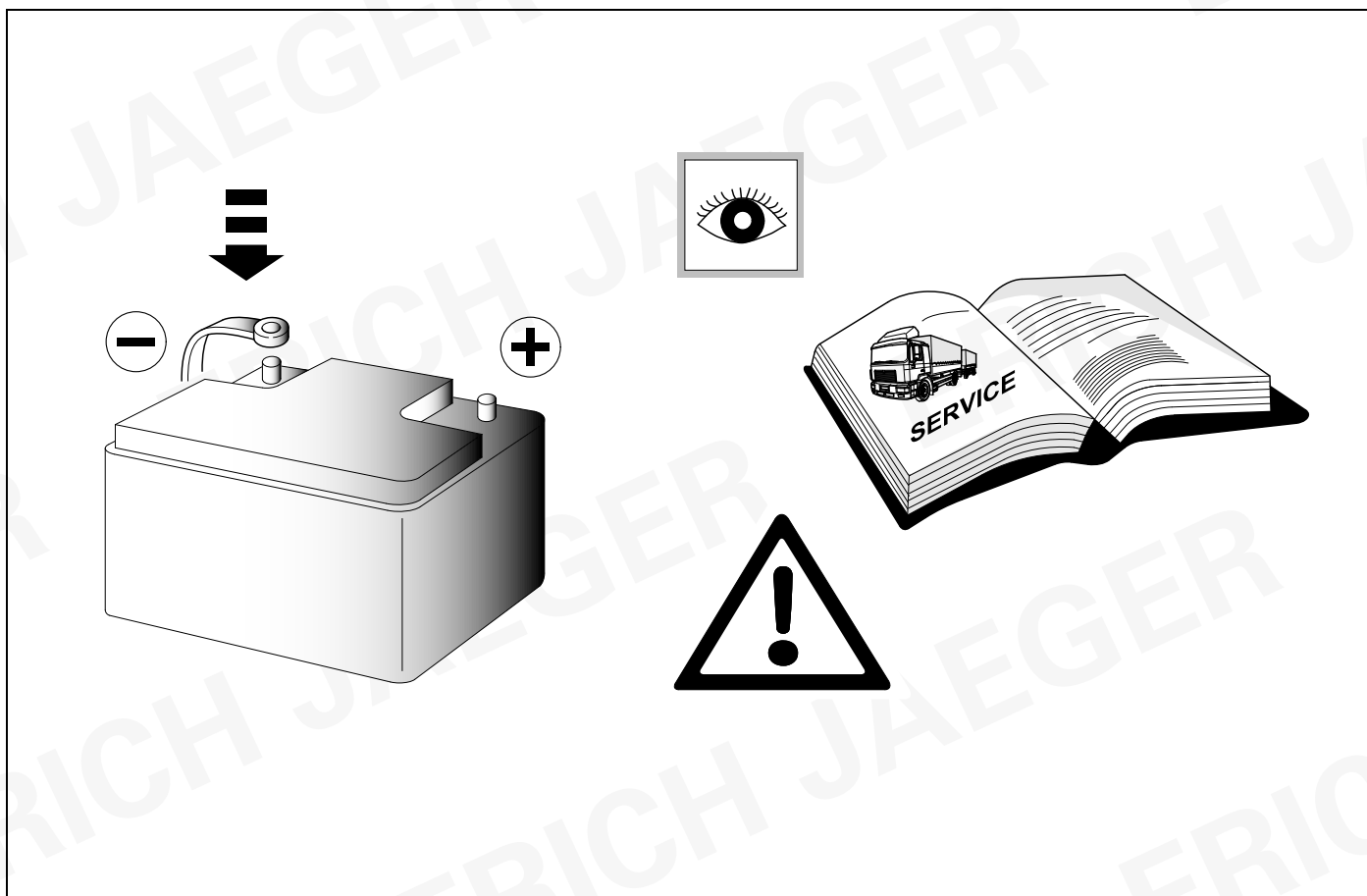

## 11 CHECK

