

Article Number: 382698 double contact sleeve

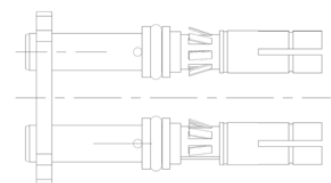

Categories	Accessories , Plug
Standards	ISO 25981
Industries	Commercial vehicles

Electrical Details and Temperature Resistance

Voltage [in V]	24
----------------	----

Material

Contact surface	nickel (Ni)
-----------------	-------------

Connectivity

Contact termination	crimp contact
Contact version	double contact sleeve
No. of poles	07
Outlet open or closed	n.a.

Measures and Dimensions

Contact: for max. wire cross section [in mm²]	6,00
---	------